

VICTORIAN RAILWAYS, BEECH FOREST TO CROWE'S 2^{FT} 6^{IN} NARROW GAUGE

SCALE 10 CHAINS TO AN INCH.

Nº1

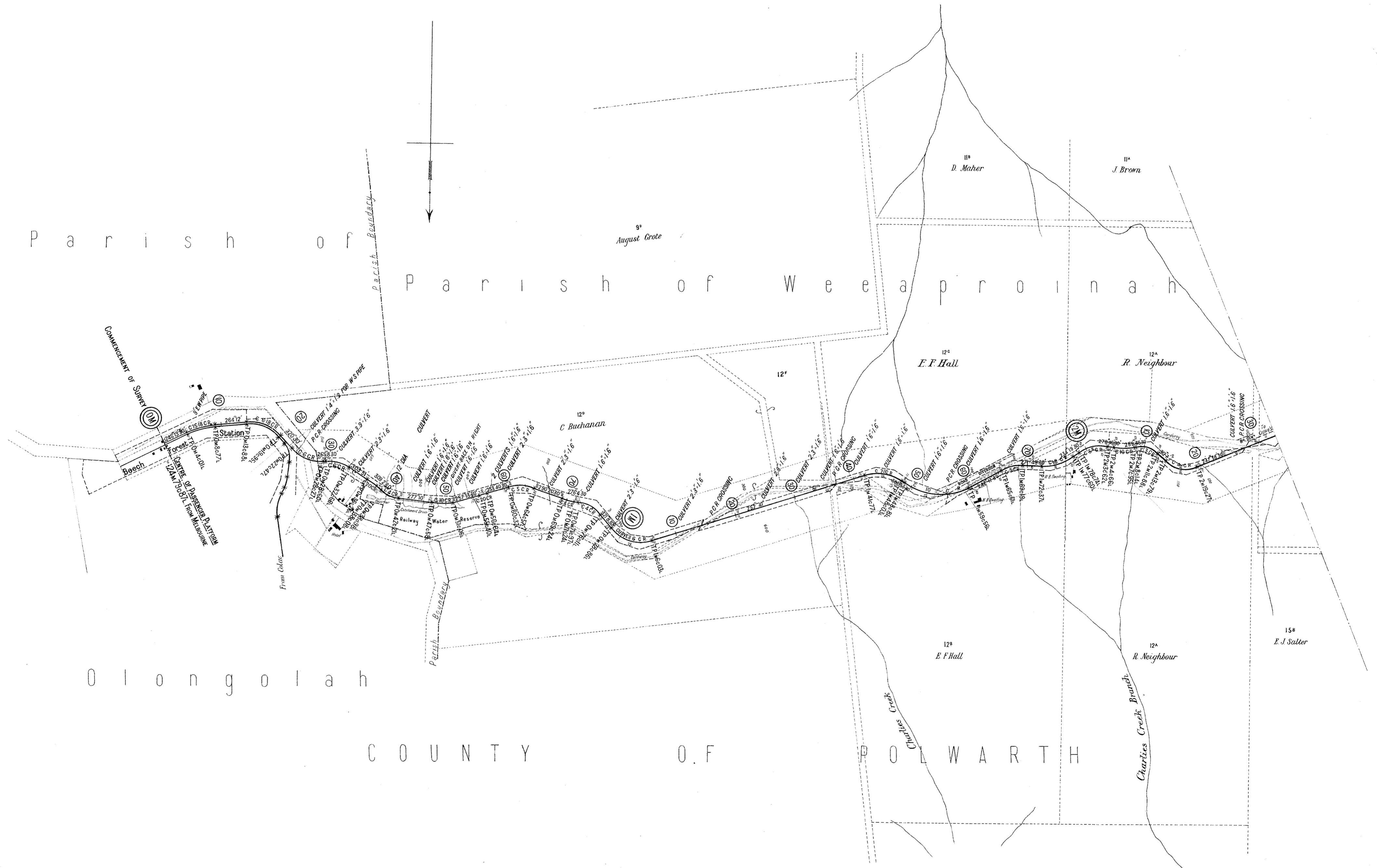

VICTORIAN RAILWAYS, BEECH FOREST TO CROWE'S 2 FT 6 IN NARROW GAUGE

SCALE 10 CHAINS TO AN INCH

No 2



VICTORIAN RAILWAYS, BEECH FOREST TO CROWE'S 2 FT 6 IN NARROW GAUGE

— SCALE — 10 CHAINS TO AN INCH

No 4



VICTORIAN RAILWAYS, BEECH FOREST TO CROWE'S 2 FT 6 IN NARROW GAUGE

— SCALE — 10 CHAINS TO AN INCH

No 5*

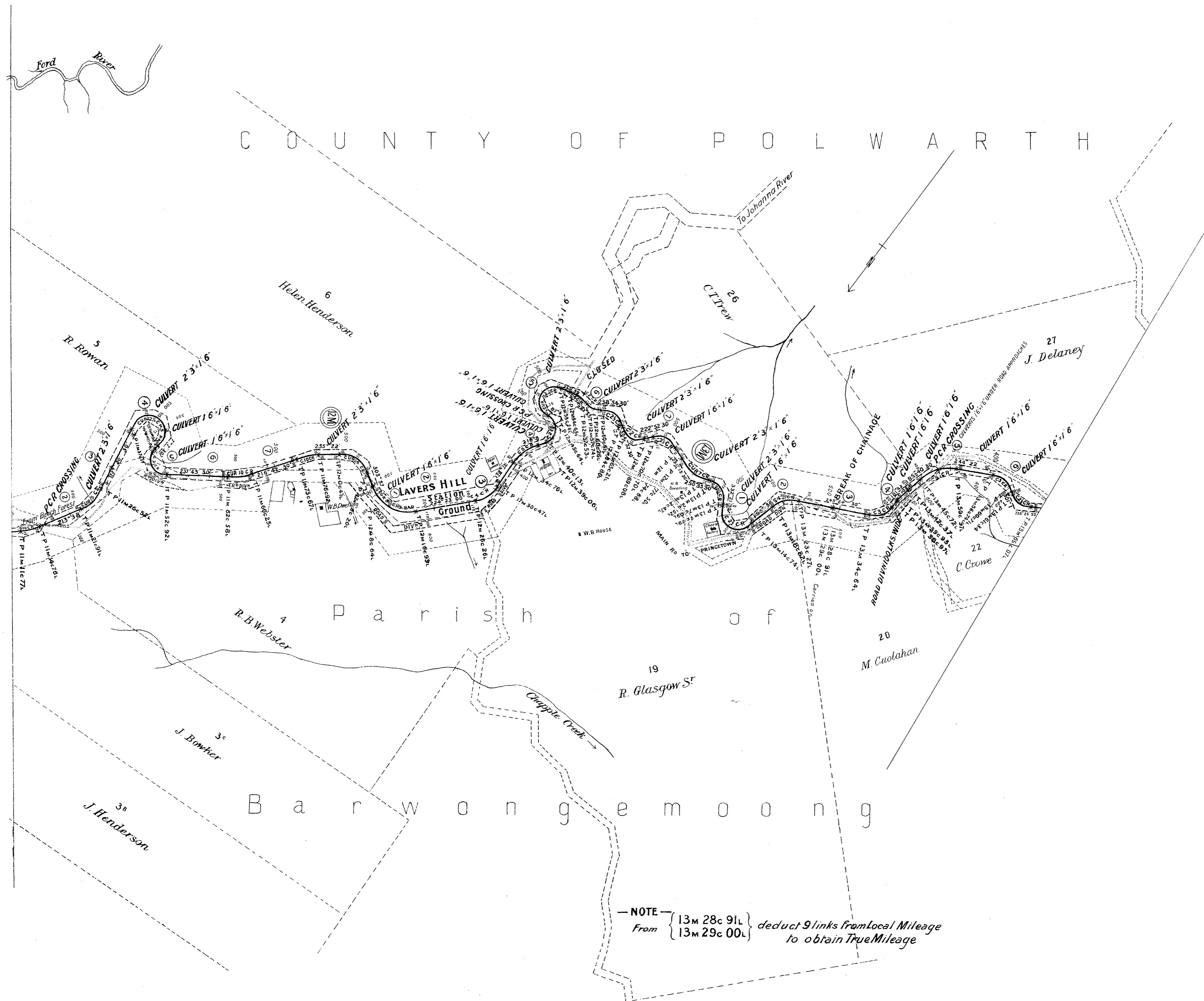

— NOTE —
From $\left. \begin{matrix} 13M\ 28c\ 91L \\ 13M\ 29c\ 00L \end{matrix} \right\}$ deduct 9 links from Local Mileage
to obtain True Mileage

VICTORIAN RAILWAYS, BEECH FOREST TO CROWE'S

2 FT 6 IN NARROW GAUGE

SCALE 10 CHAINS TO AN INCH

No 6

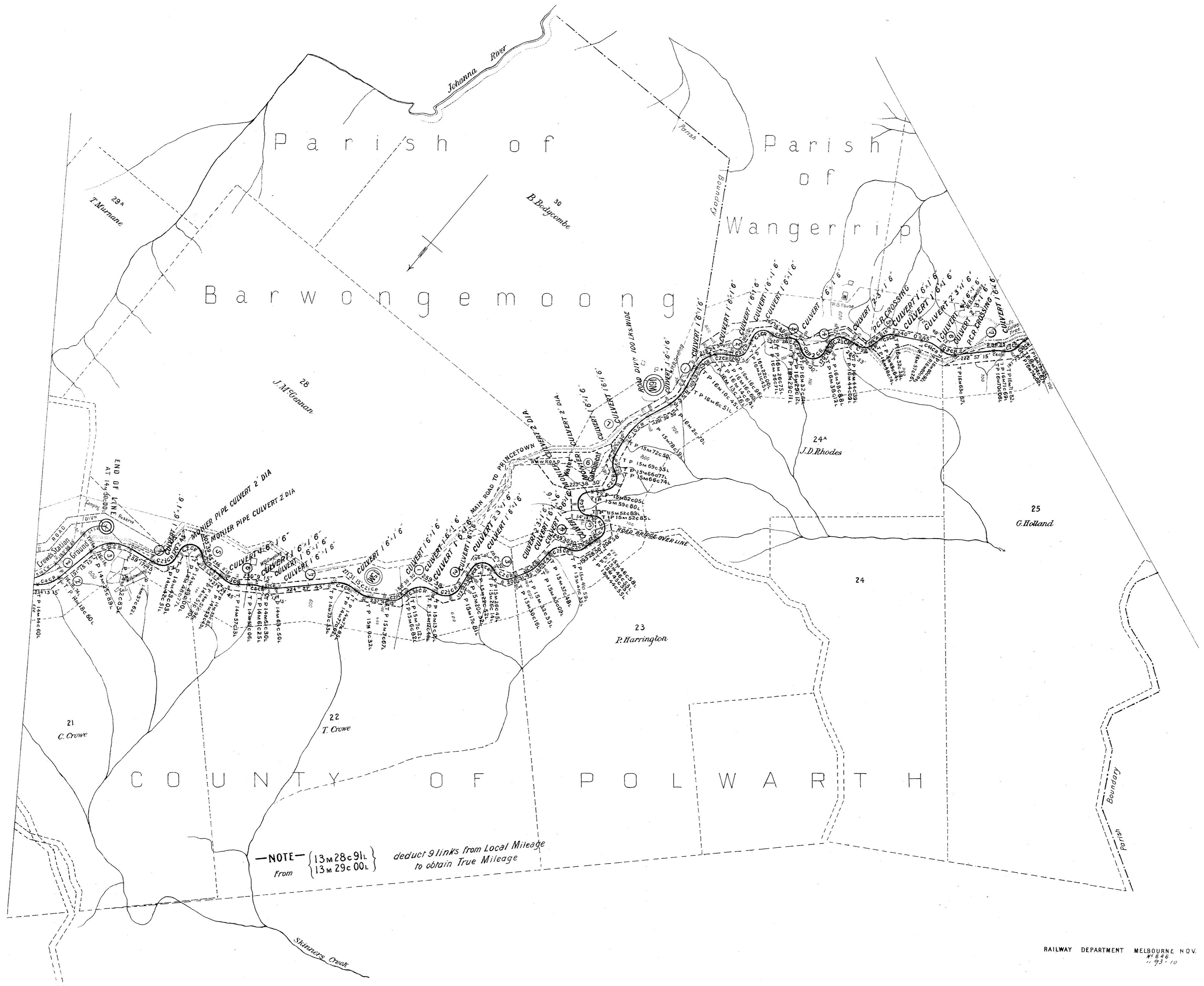

NOTE — From $\left. \begin{matrix} 13M 28c 9L \\ 13M 29c 00L \end{matrix} \right\}$ deduct 9 links from Local Mileage to obtain True Mileage

VICTORIAN RAILWAYS, BEECH FOREST TO CROWE'S

2 FT 6 IN NARROW GAUGE

— SCALE — 10 CHAINS TO AN INCH

Nº 7



— NOTE —
 FROM $\left. \begin{matrix} 13m28c9l \\ 13m29c00l \end{matrix} \right\}$ deduct 9 links from Local Mileage
 to obtain true Mileage

Parish of Weeapronah

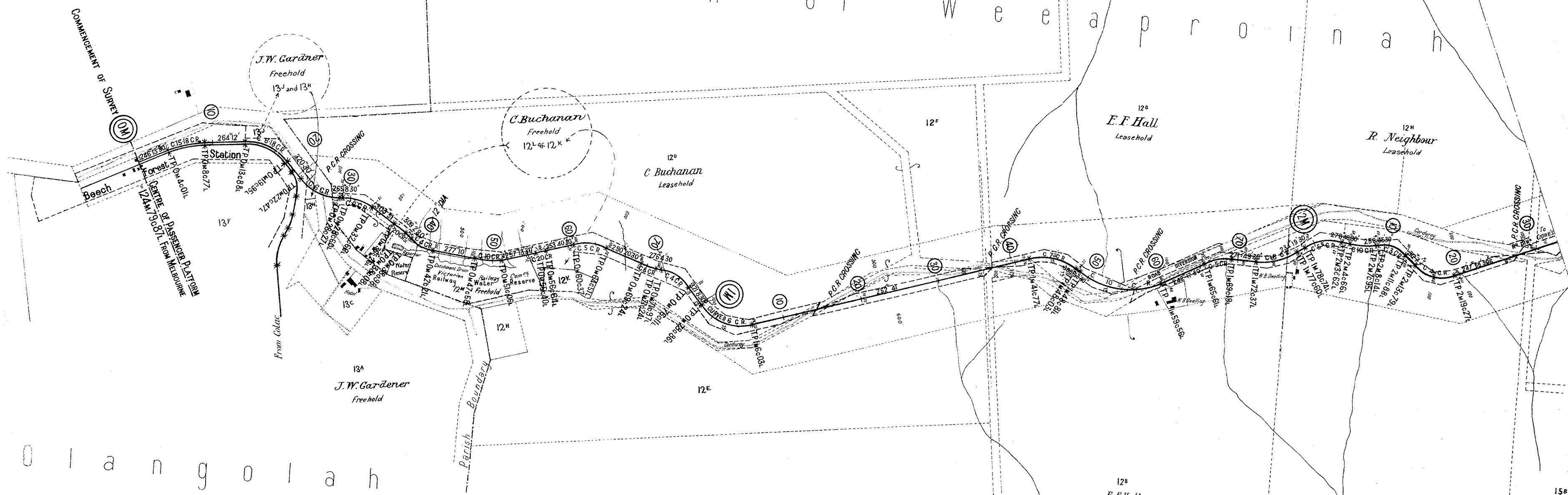

**VICTORIAN RAILWAYS,
BEECH FOREST TO CROWE'S**

2 FT 6 IN NARROW GAUGE

Plan of Land belonging to _____ occupied by _____

Situated in the Parish of _____ in the County of Polwarth

SCALE 10 CHAINS TO ONE INCH

Quantity of Land required and colored red ^{A. R. P.} more or less.

① Reference No. _____

P a r i s h
o f
W e e a p r o i n a h

P a r i s h
o f
W y e l a n g t a

Crown Land

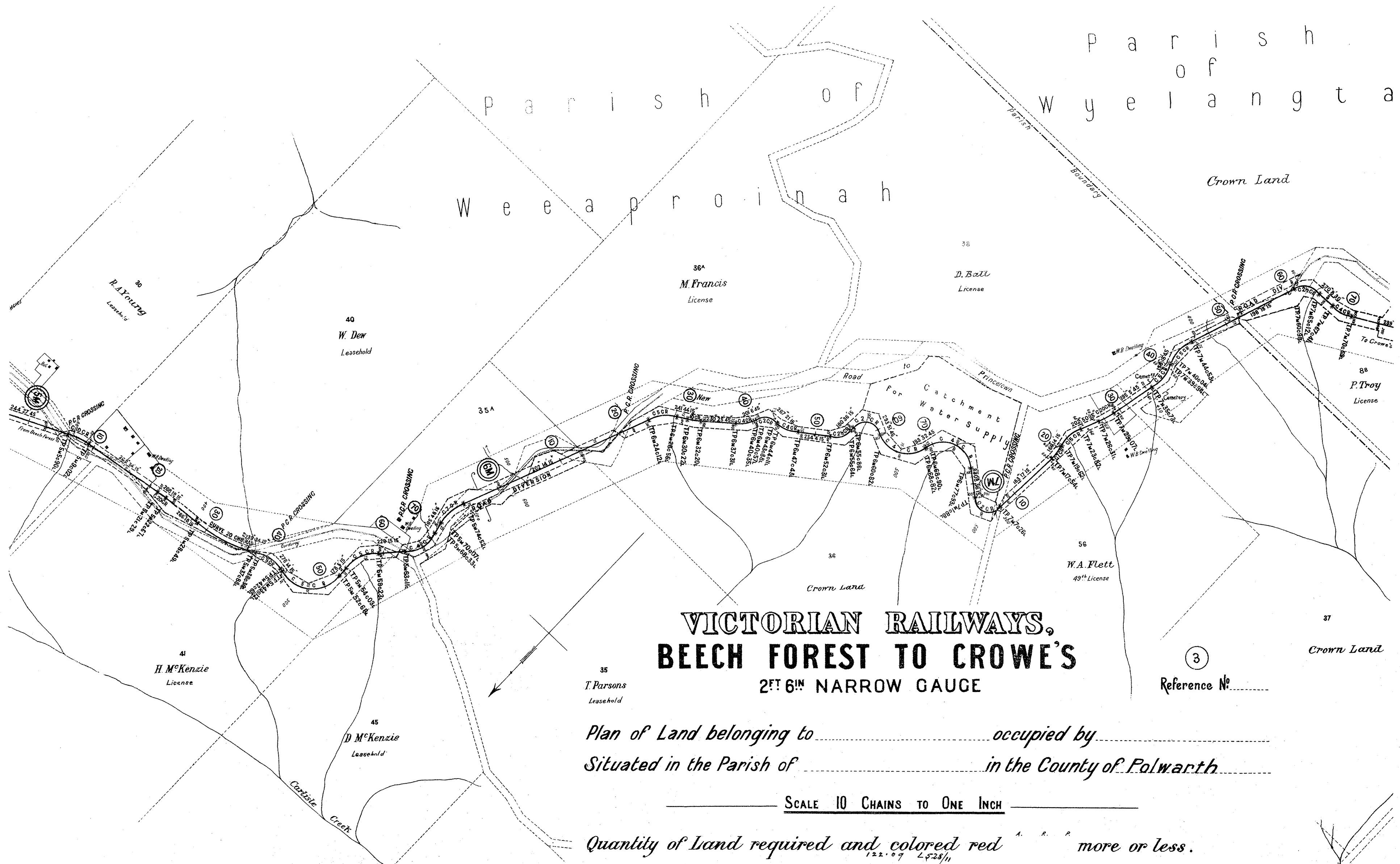

**VICTORIAN RAILWAYS,
BEECH FOREST TO CROWE'S
2 FT 6 IN NARROW GAUGE**

Plan of Land belonging to occupied by
 Situated in the Parish of in the County of Palwarth

SCALE 10 CHAINS TO ONE INCH

Quantity of Land required and colored red more or less.

③
Reference No.

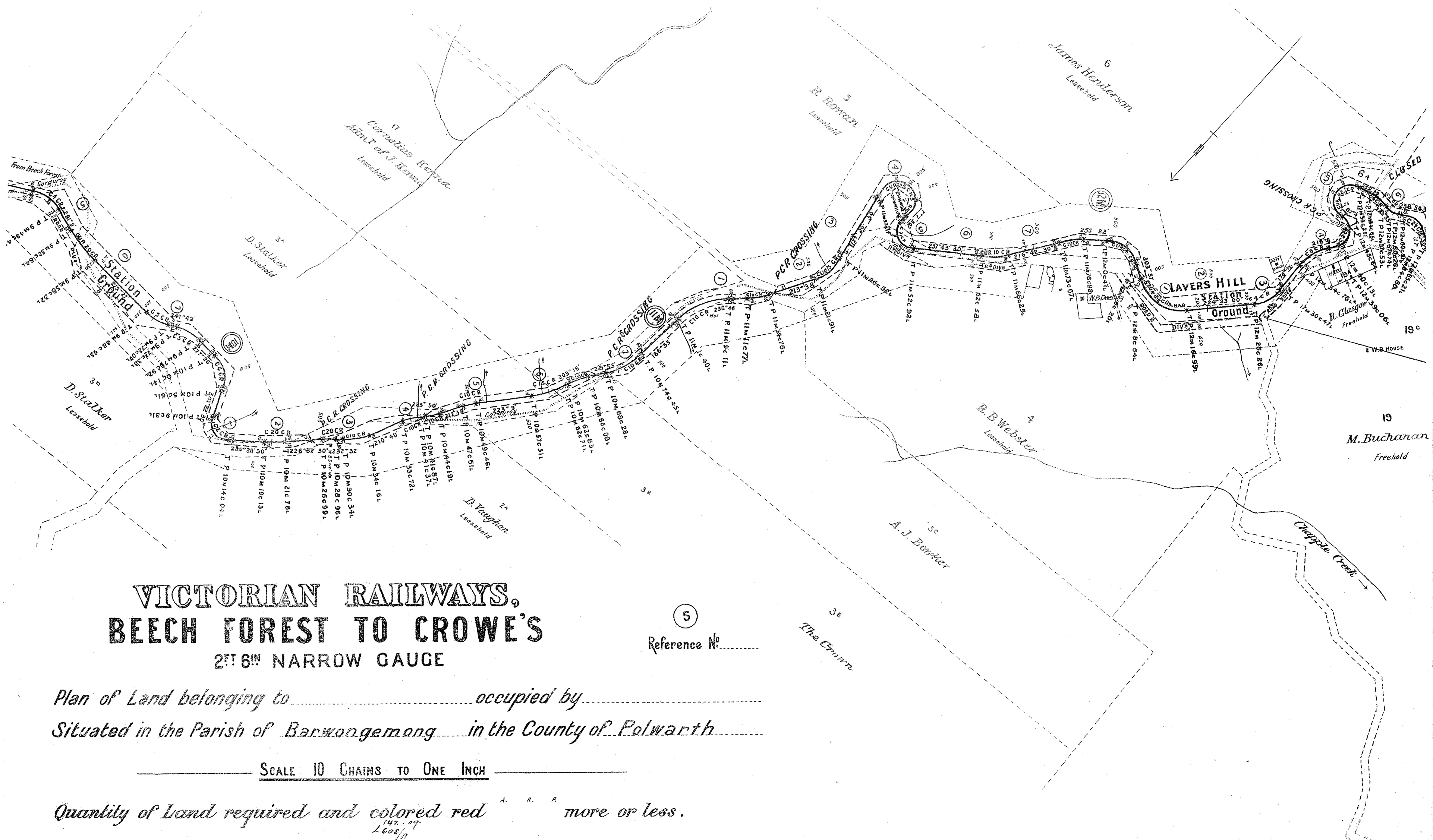

**VICTORIAN RAILWAYS,
BEECH FOREST TO CROWE'S
2 FT 6 IN NARROW GAUGE**

5
Reference No.

Plan of Land belonging to occupied by
Situating in the Parish of Barwongemang in the County of Polwarth

SCALE 10 CHAINS TO ONE INCH

Quantity of Land required and colored red more or less.
142.09
1605/11

VICTORIAN RAILWAYS, BEECH FOREST TO CROWE'S 2 FT 6 IN NARROW GAUGE

6
Reference No.

Plan of Land belonging to occupied by
Situating in the Parish of Barwongemong in the County of Polwarth

SCALE 10 CHAINS TO ONE INCH

Quantity of Land required and colored red ^{A. K. P.} more or less.

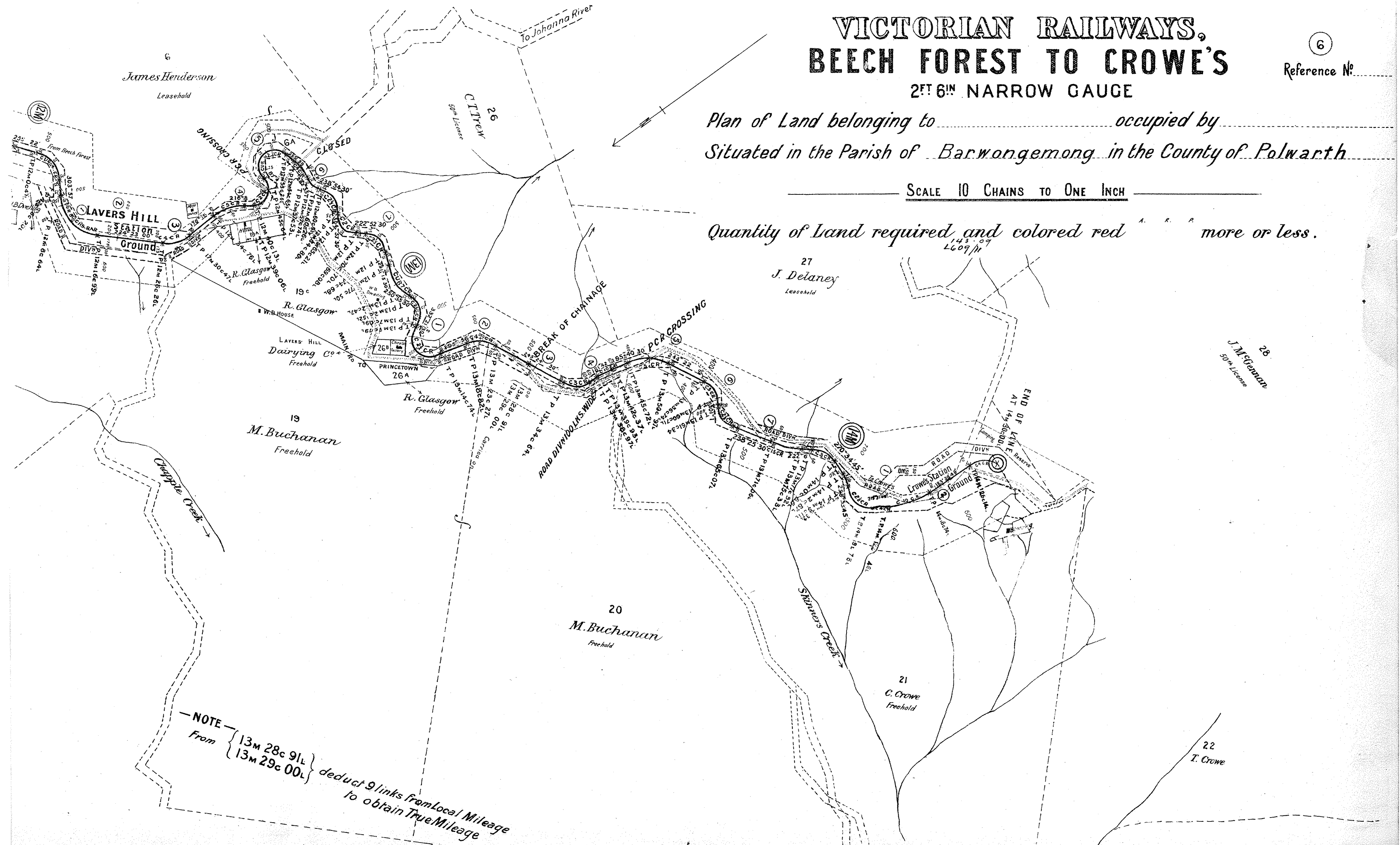

VICTORIAN RAILWAYS, BEECH FOREST TO CROWE'S

Nº 1

The figures under the description of the Curves at the bottom of the Section denote the super-elevation of the outer rail; Speed 15 miles an hour.

— SCALES — HORIZONTAL: 4 CHAINS TO AN INCH.
VERTICAL: 40 FEET TO AN INCH.

COMMENCEMENT OF SURVEY
CENTRE OF PASSENGER PLATFORM
BEECH FOREST STATION
1040.00
124m 79c 87L
LOCAL MILEAGE
1744.60
1744.62
1744.64
1744.66
1744.68
1744.70
1744.72
1744.74
1744.76
1744.78
1744.80
1744.82
1744.84
1744.86
1744.88
1744.90
1744.92
1744.94
1744.96
1744.98
1745.00

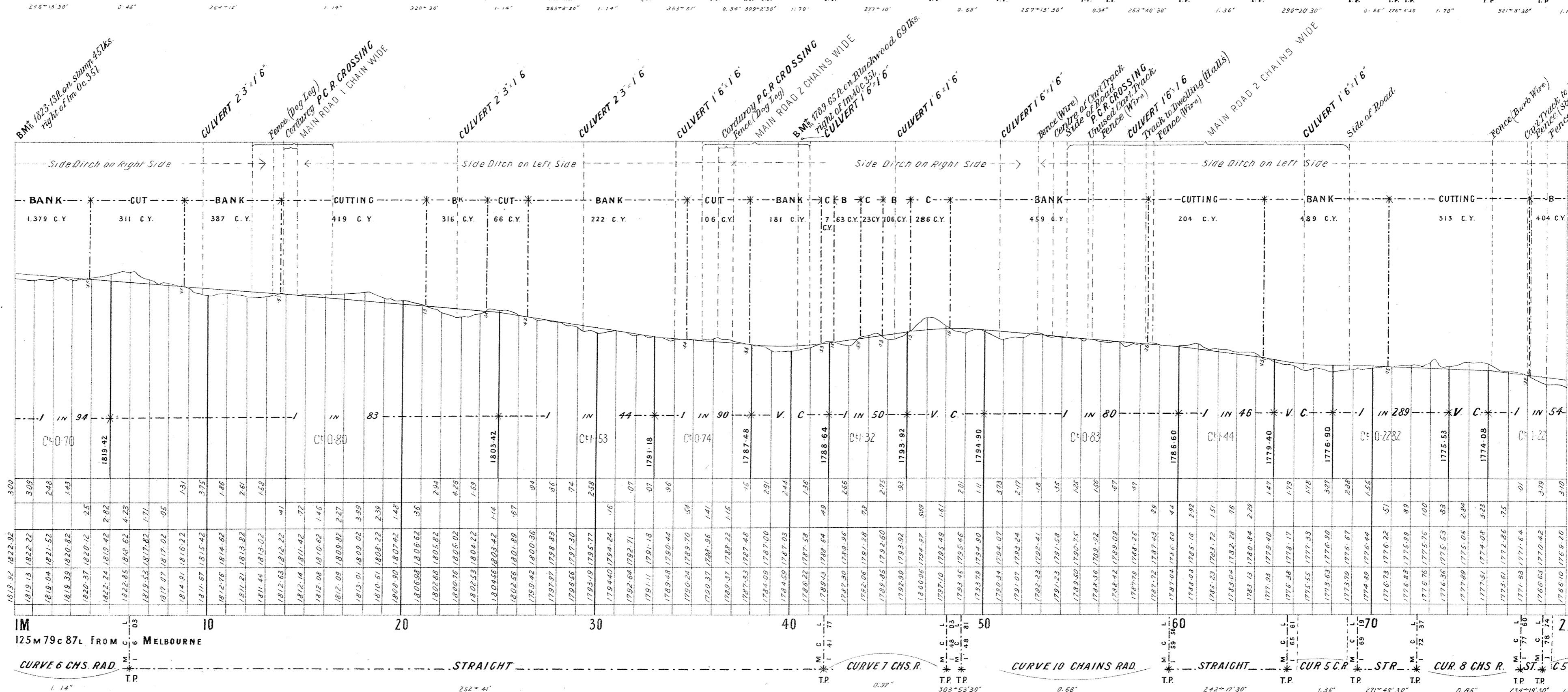
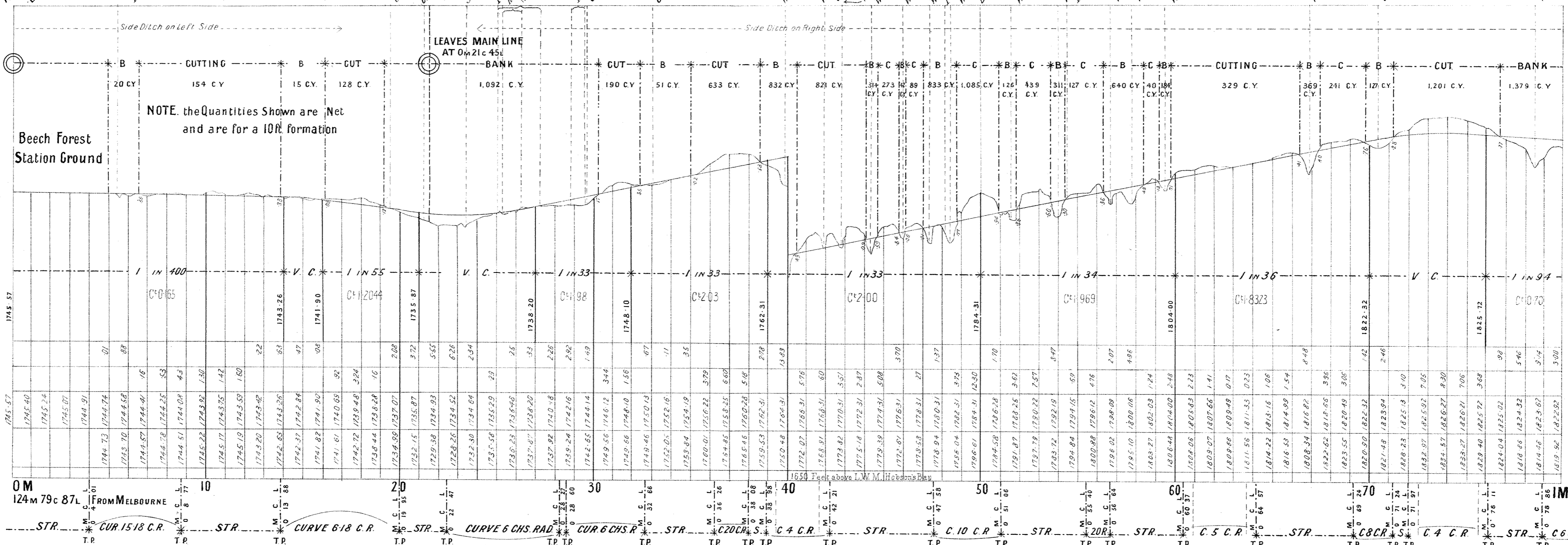

VICTORIAN RAILWAYS, BEECH FOREST TO CROWE'S

2 FT 6 IN NARROW GAUGE

No 2

The figures under the description of the Curves at the bottom of the Section denote the super-elevation of the outer rail; Speed 15 miles an hour.

— SCALES —
HORIZONTAL. 4 CHAINS TO AN INCH.
VERTICAL. 40 FEET TO AN INCH.

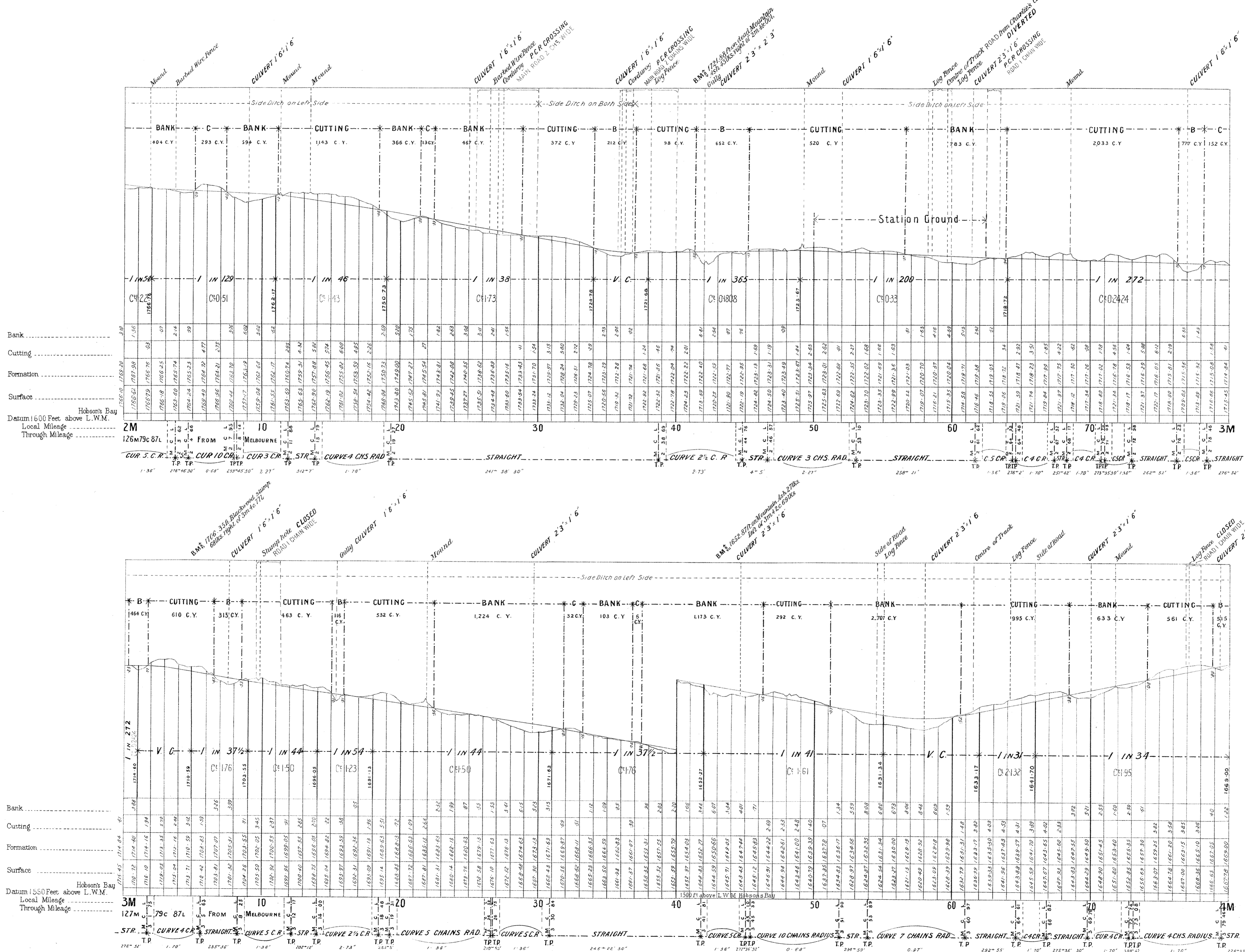

VICTORIAN RAILWAYS, BEECH FOREST TO CROWE'S 2 FT 6 IN NARROW GAUGE

The figures under the description of the Curves at the bottom of the Section denote the super-elevation of the outer rail; Speed 16 miles an hour.

SCALES { HORIZONTAL, 4 CHAINS TO AN INCH.
VERTICAL, 40 FEET TO AN INCH.

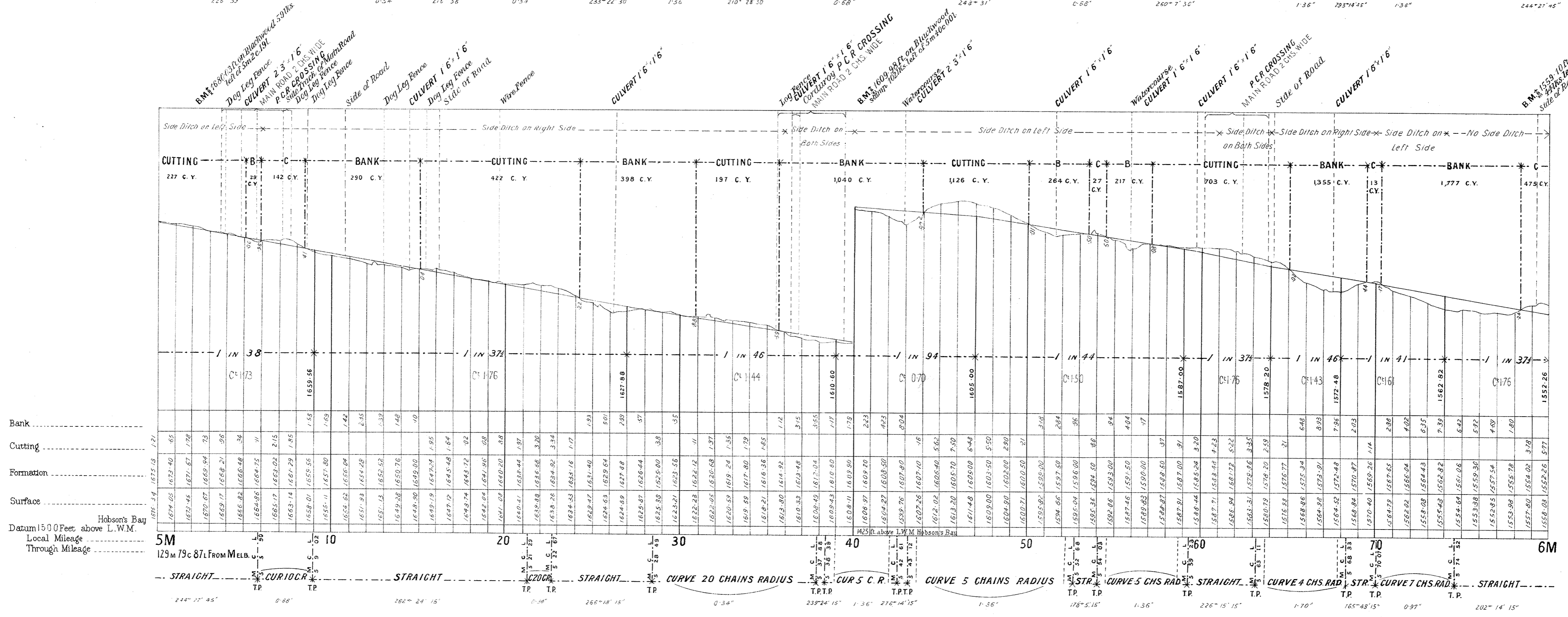
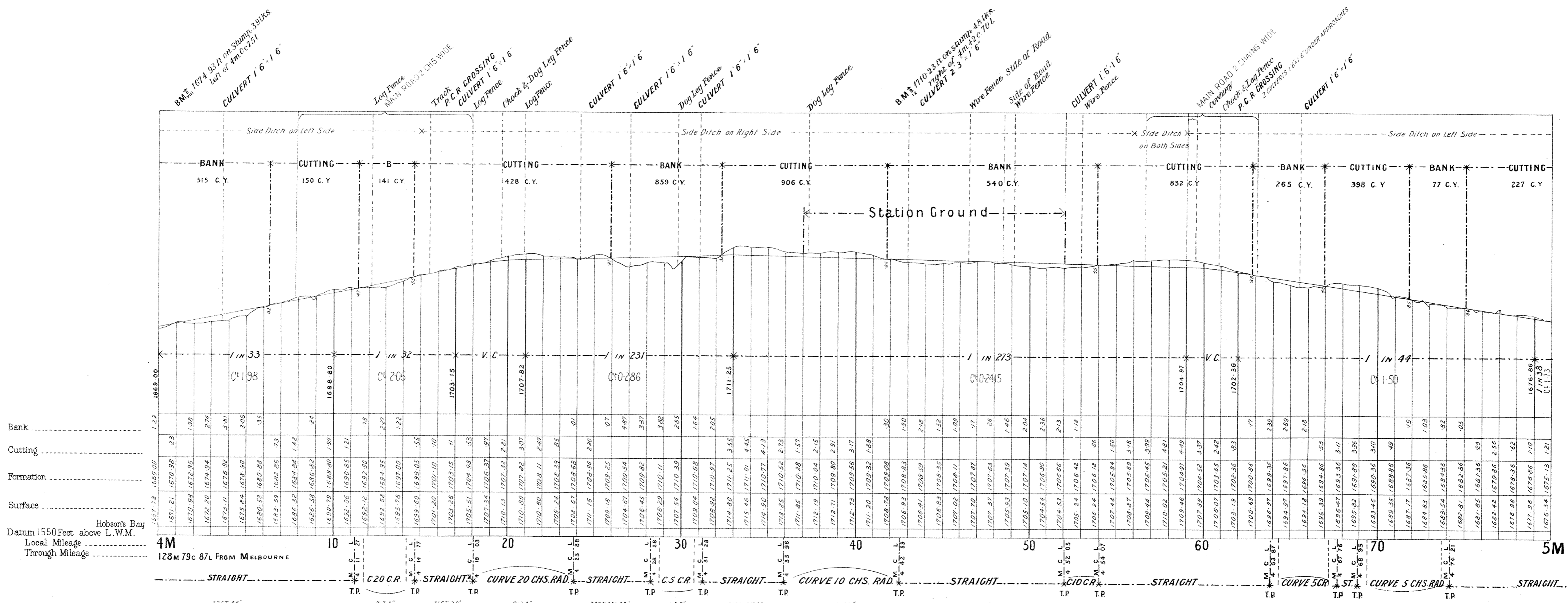

VICTORIAN RAILWAYS, BEECH FOREST TO CROWE'S

2 FT 6 IN NARROW GAUGE

No 4

The figures under the description of the Curves at the bottom of the Section denote the super-elevation of the outer rail; Speed 15 miles an hour.

SCALES { HORIZONTAL. 4 CHAINS TO AN INCH.
VERTICAL. 40 FEET TO AN INCH.

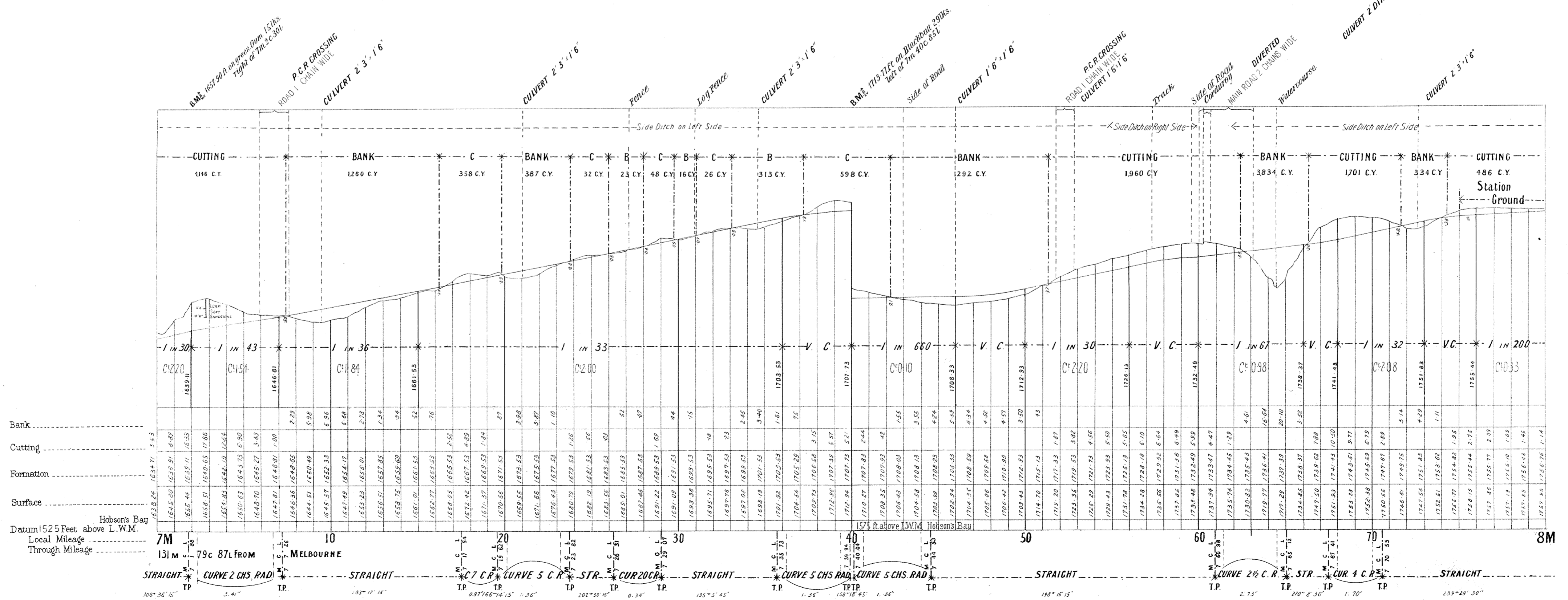
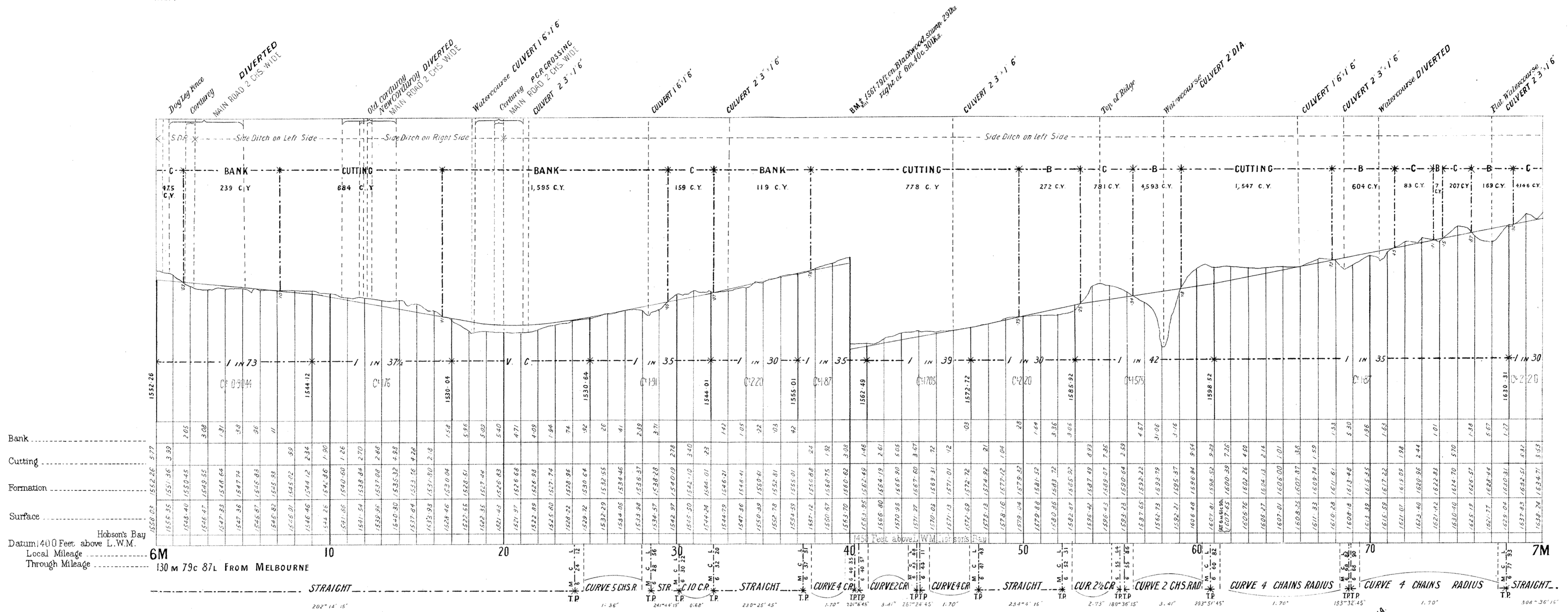

VICTORIAN RAILWAYS, BEECH FOREST TO CROWE'S

2 FT 6 IN NARROW GAUGE

— SCALES — (HORIZONTAL, 4 CHAINS TO AN INCH.
VERTICAL, 40 FEET TO AN INCH.

No 5

The figures under the description of the Curves at the bottom of the Section denote the super-elevation of the outer rail; Speed 15 miles an hour.

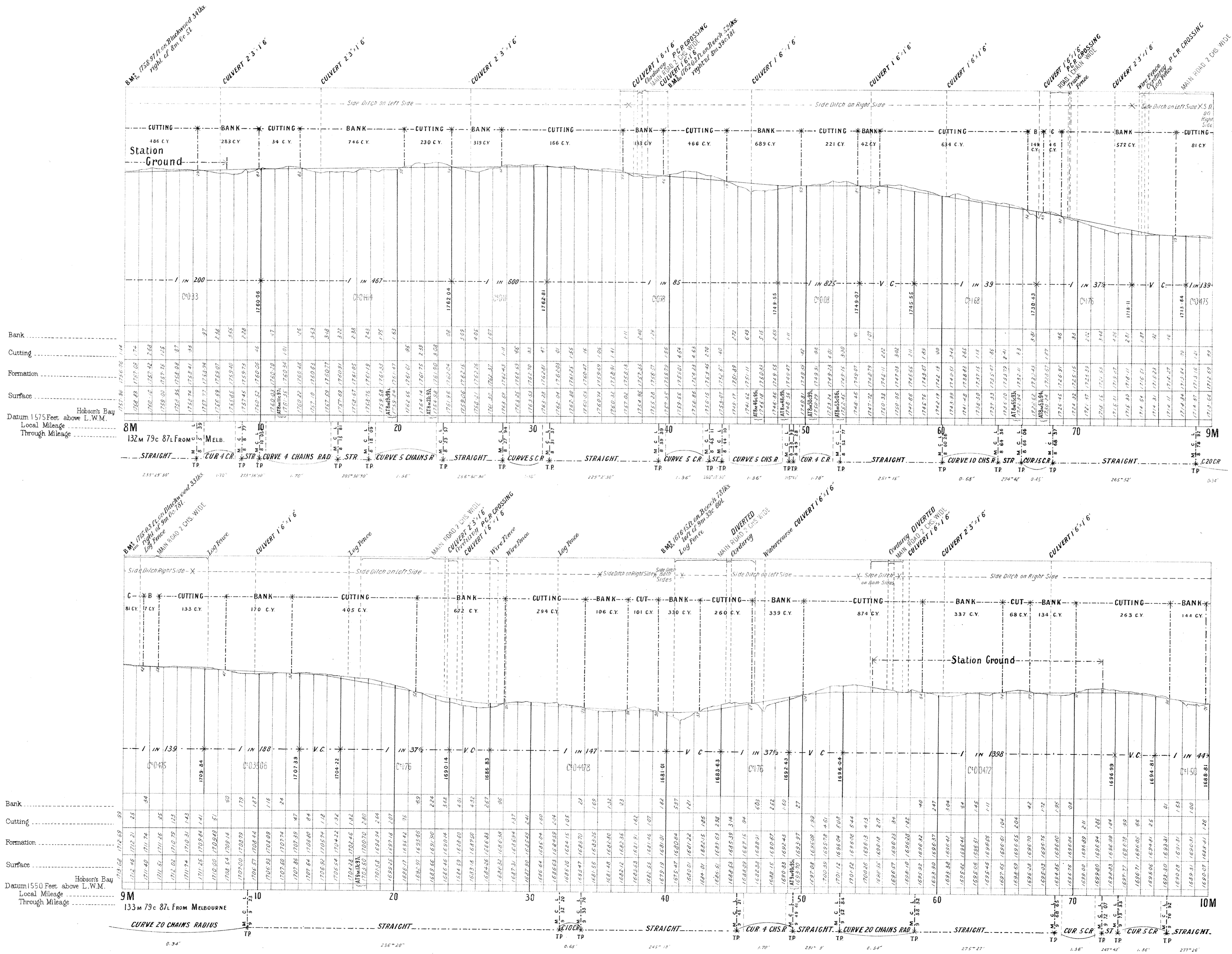

VICTORIAN RAILWAYS, BEECH FOREST TO CROWE'S

2 FT 6 IN NARROW GAUGE

No 6

The figures under the description of the Curves at the bottom of the Section denote the super-elevation of the outer rail; Speed 15 miles an hour.

SCALES { HORIZONTAL, 4 CHAINS TO AN INCH.
VERTICAL, 40 FEET TO AN INCH.

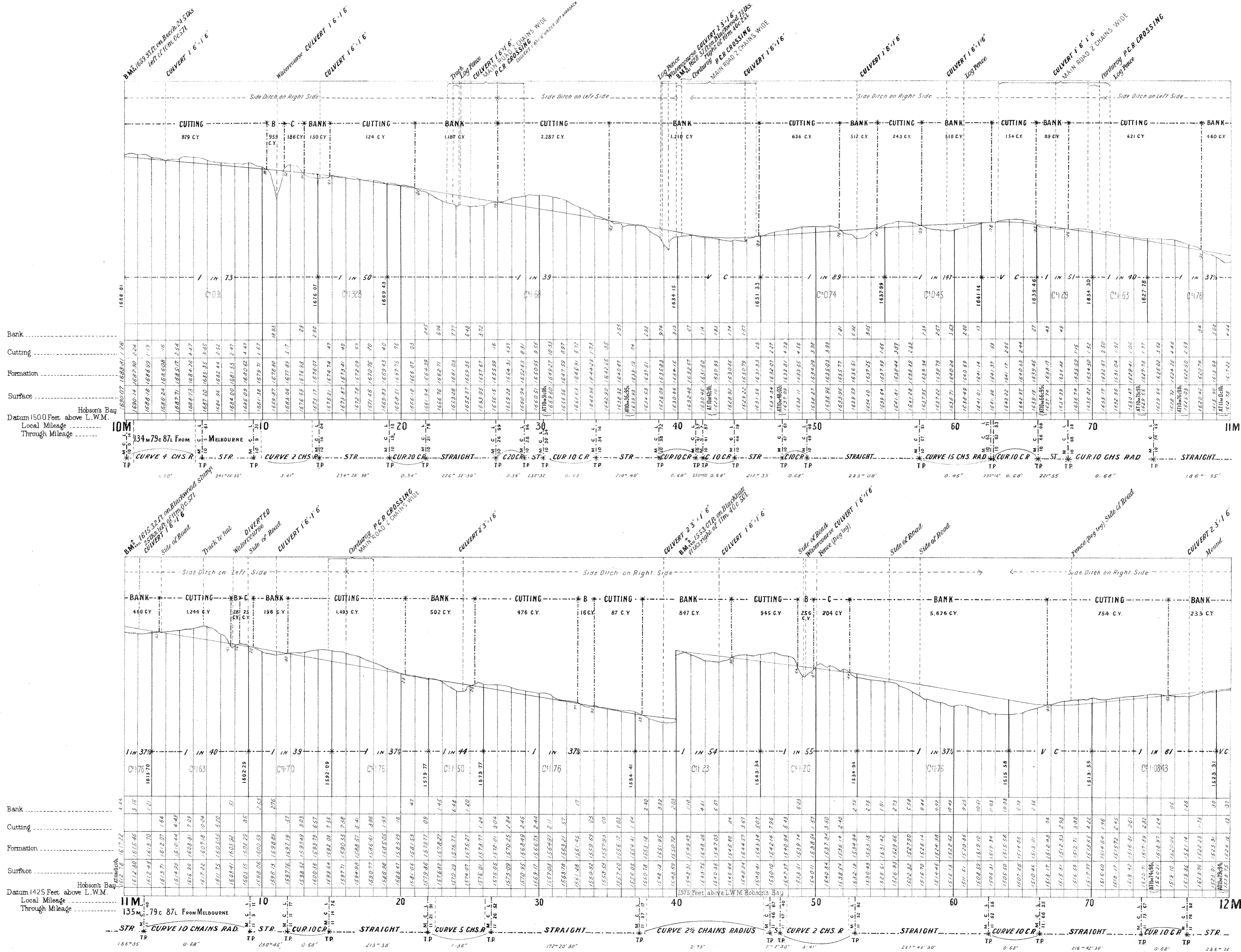

VICTORIAN RAILWAYS. BEECH FOREST TO CROWE'S

2 FT 6 IN NARROW GAUGE

No 7

The figures under the description of the Curves at the bottom of the Section denote the super-elevation of the outer rail; Speed 15 miles an hour.

SCALES { HORIZONTAL, 4 CHAINS TO AN INCH.
VERTICAL, 40 FEET TO AN INCH.

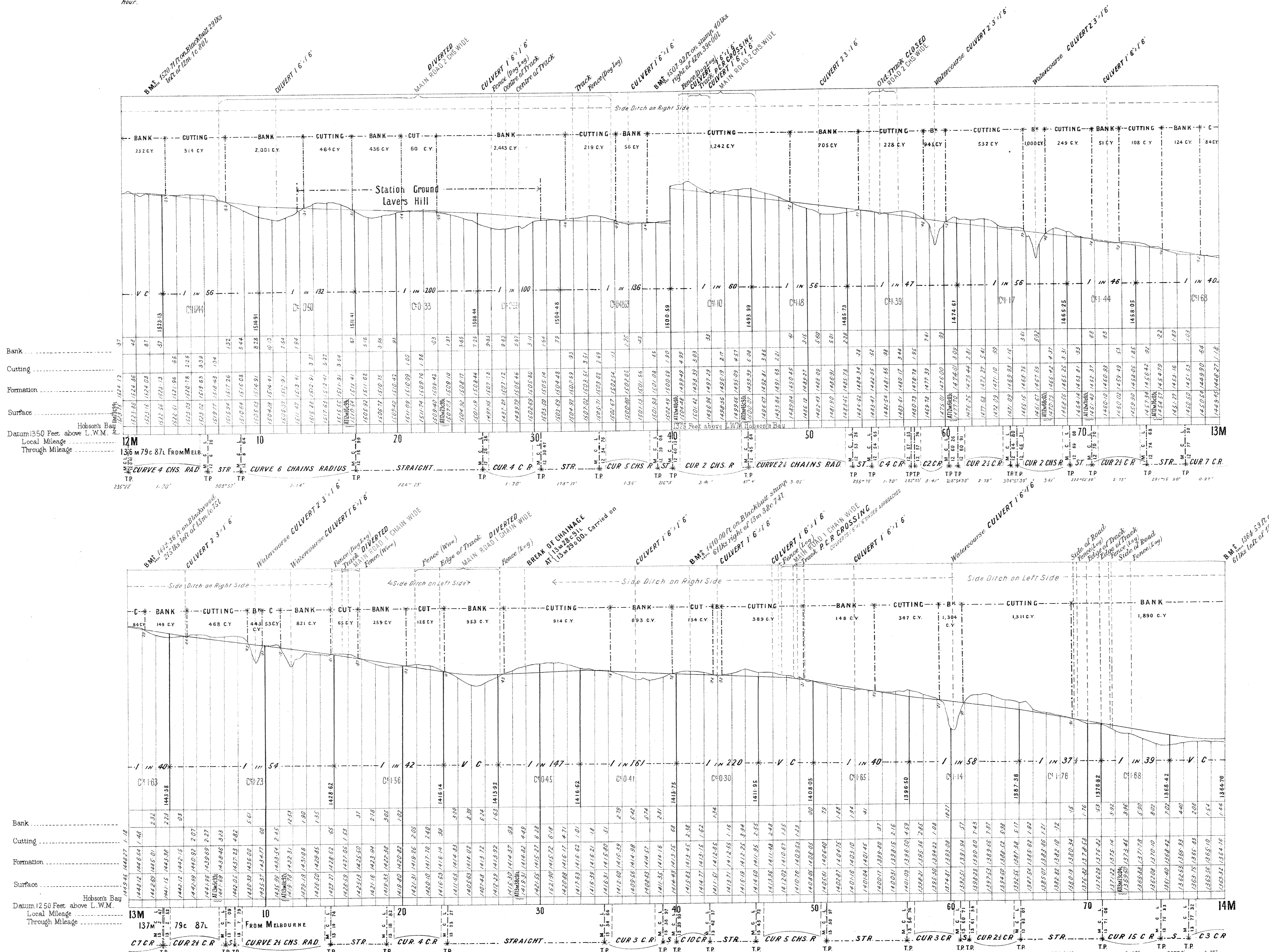

NOTE — FROM { 13m 28c 91l
13m 29c 00l } deduct 9 links from Local Mileage to obtain True Mileage

VICTORIAN RAILWAYS, BEECH FOREST TO CROWE'S

2 FT 6 IN NARROW GAUGE

No 8*

— SCALES —
HORIZONTAL, 4 CHAINS TO AN INCH.
VERTICAL, 40 FEET TO AN INCH.

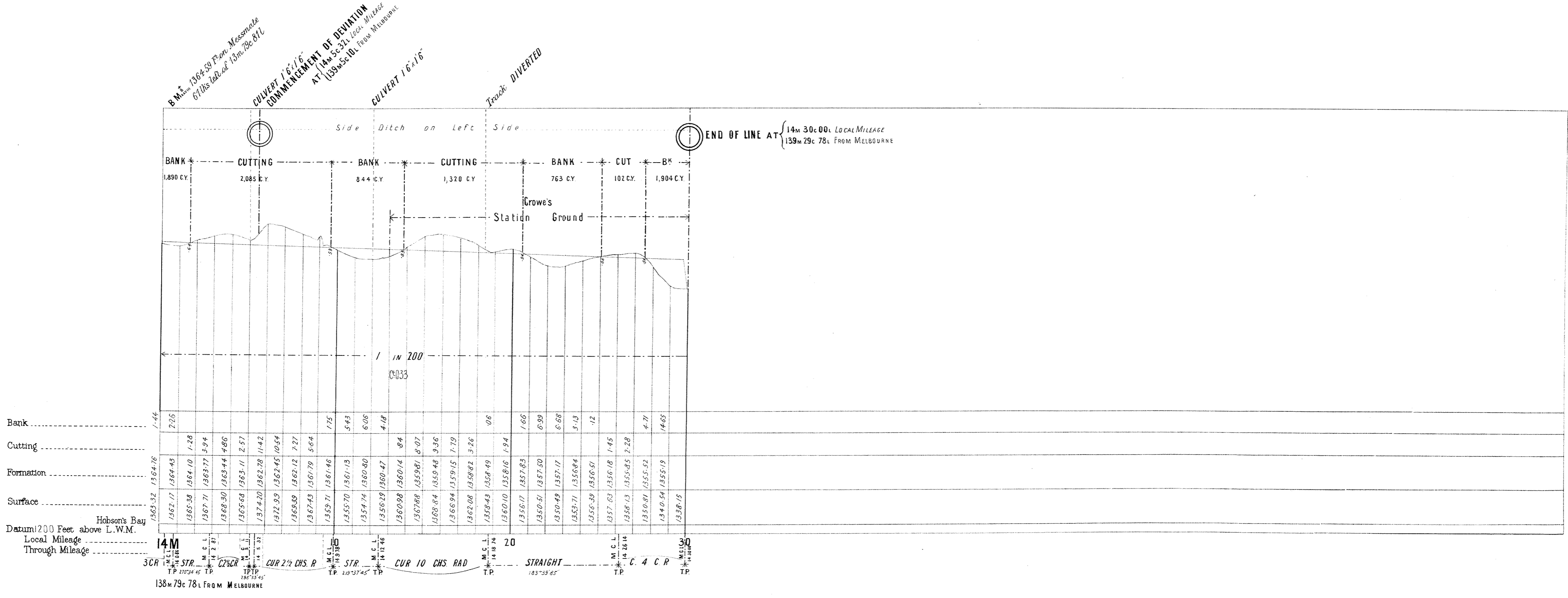

TO BEECH FOREST.
 Section of Reversif Loop at Beech Forest

R. J. J. J.

*Graded
 via
 4/7/02*

*M.S.
 29,622.96 End of Rails*

*M.S.
 29,799.48 = 29,671.10*

HORIZONTAL - SCALE 4 CHAINS TO 1 INCH.
 VERTICAL - SCALE 40 FEET TO 1 INCH.



Local Mileage Through "

69
 5.7.2