

VICTORIAN RAILWAYS, MAFFRA AND BRIAGOLONG LINE.

SCALE. 10 CHAINS TO AN INCH

CONTRACT N^o 3253.
N^o 1.

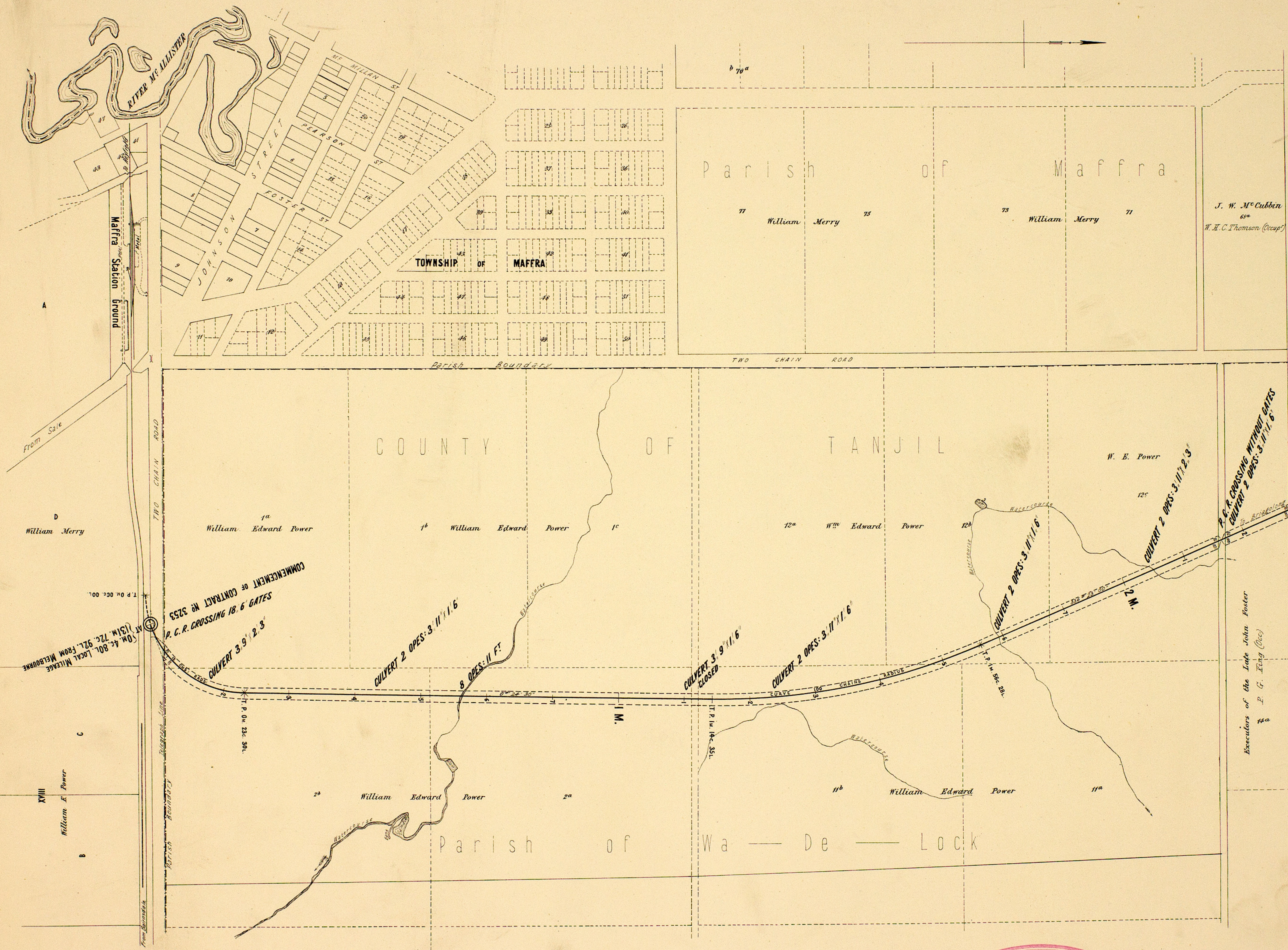

VICTORIAN RAILWAYS, MAFFRA AND BRIAGOLONG LINE

SCALE: 10 CHAINS TO AN INCH

CONTRACT N^o 3253.
N^o 2.

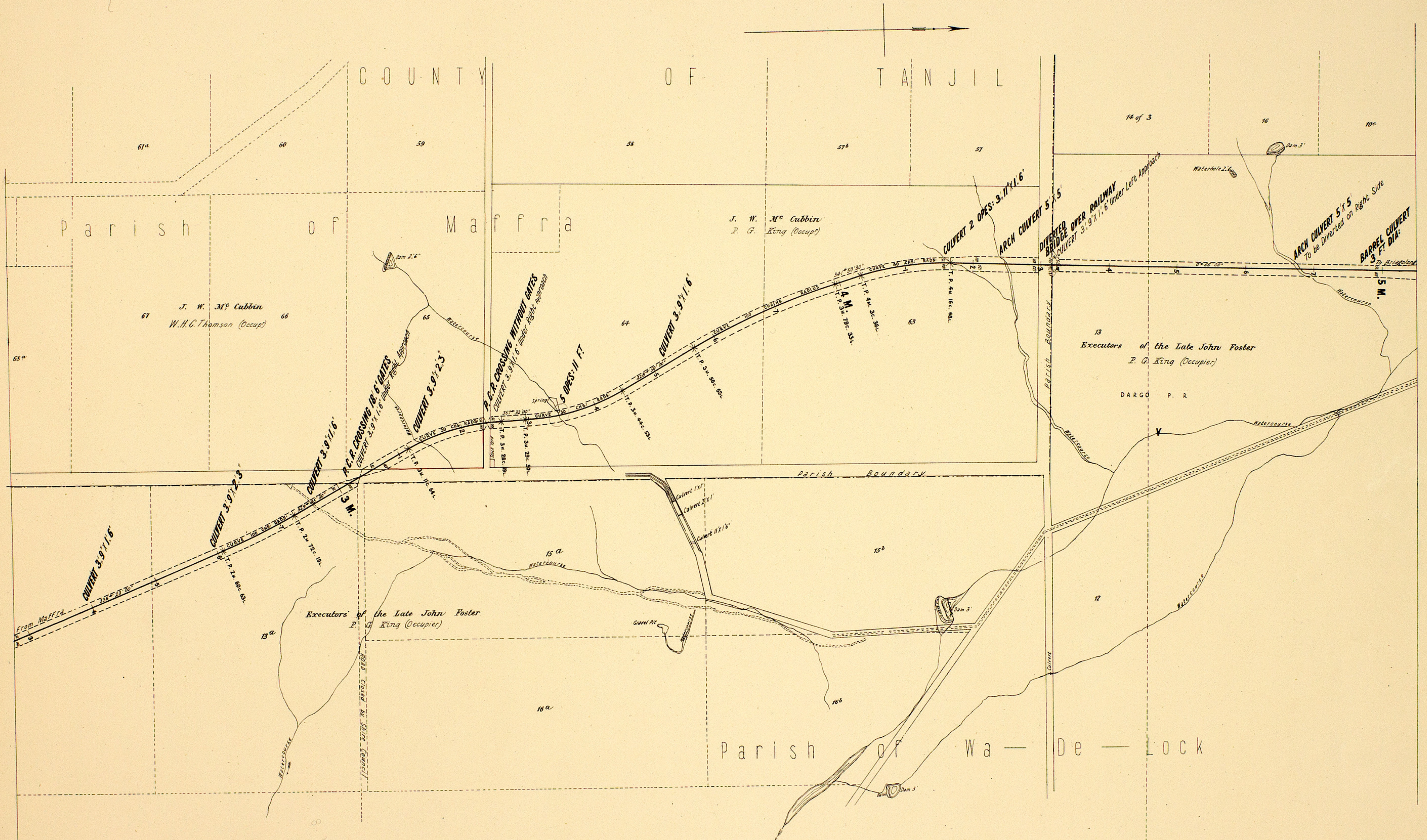

VICTORIAN RAILWAYS, MAFFRA AND BRIAGOLONG LINE.

SCALE, 10 CHAINS TO AN INCH

CONTRACT N^o 3253.
N^o 4.

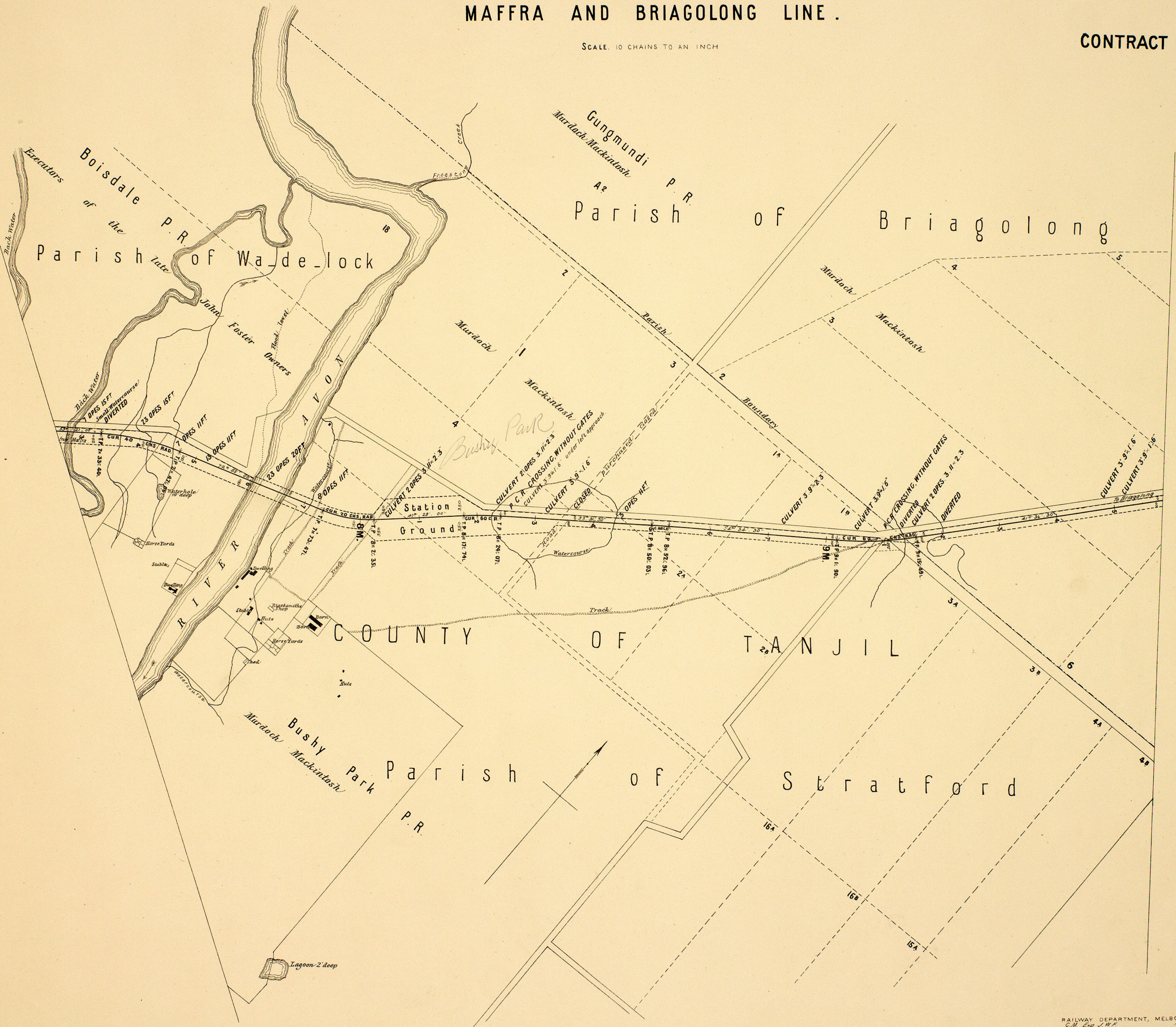

VICTORIAN RAILWAYS, MAFFRA AND BRIAGOLONG LINE.

SCALE. 10 CHAINS TO AN INCH

CONTRACT N^o 3253.
N^o 5.

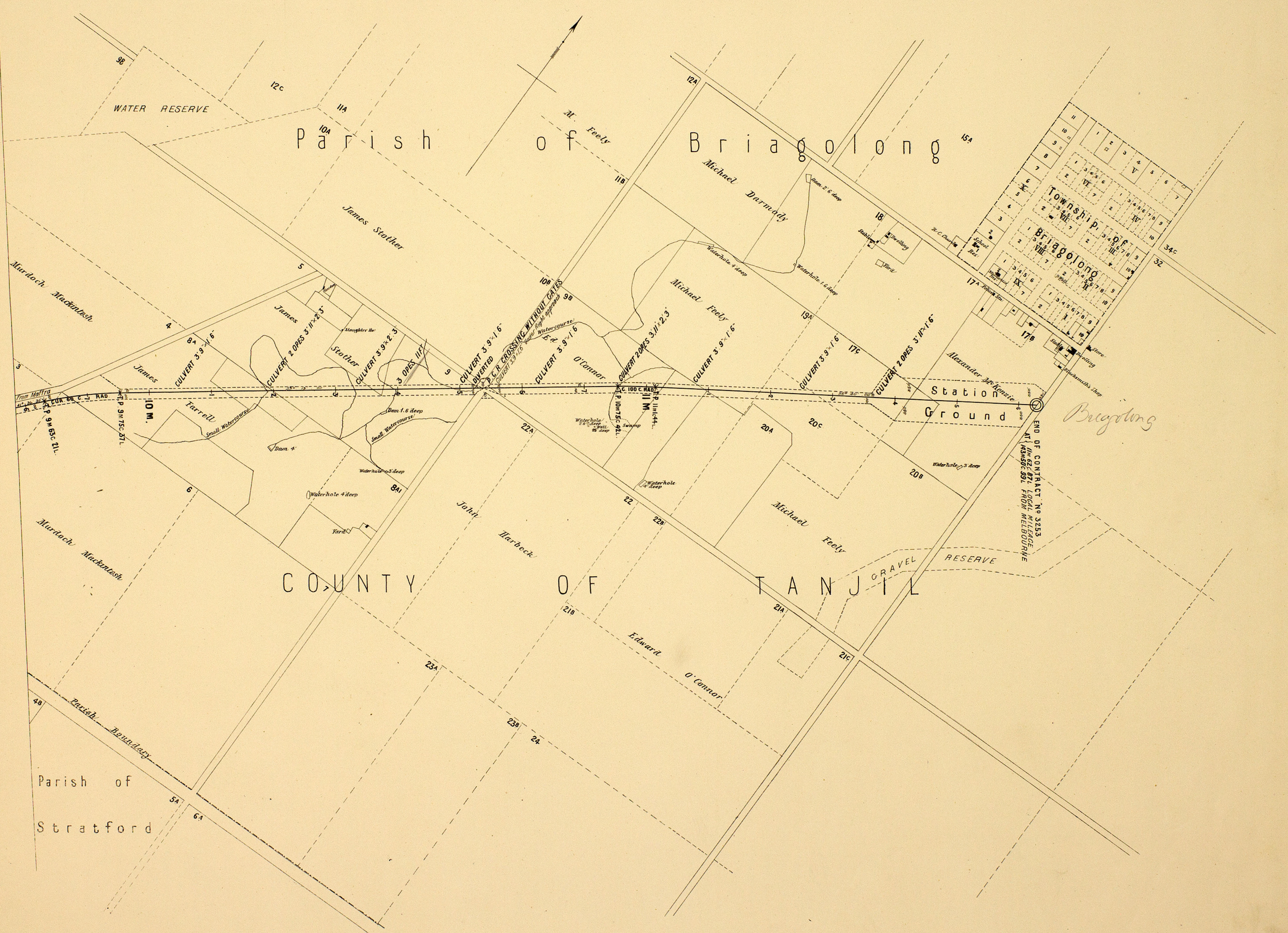

NOTE - Contractors must form their own judgment as to the nature of the Excavations, Borings and other information shown on these Sections are derived from the Surveyors' notes but are not guaranteed as correct, and the Corporation will not incur any responsibility in respect thereof.

The Figures under the description of the Curves at the bottom of the Section denote the super-elevation of the outer rail; speed 30 miles an hour.

VICTORIAN RAILWAYS, MAFFRA AND BRIAGOLONG LINE.

SCALES: HORIZONTAL 4 CHAINS TO AN INCH.
VERTICAL 40 FEET TO AN INCH.

CONTRACT NO 3253.
NO 1

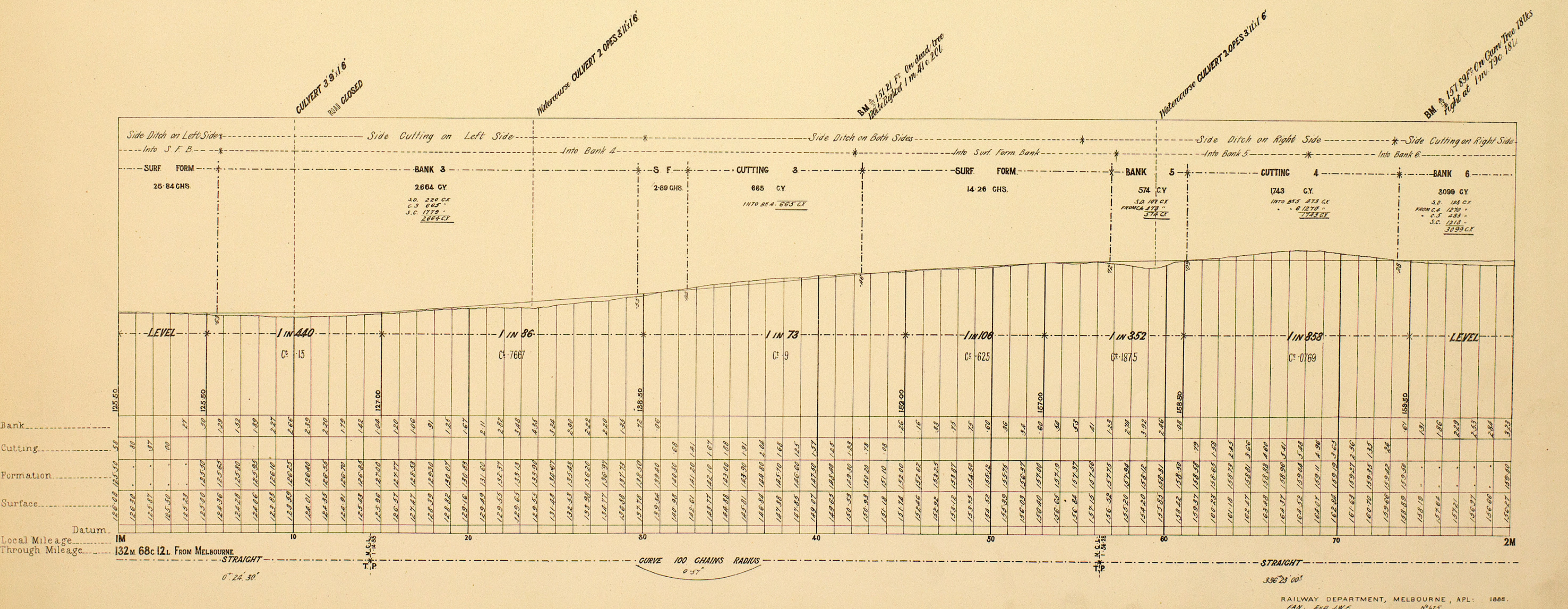
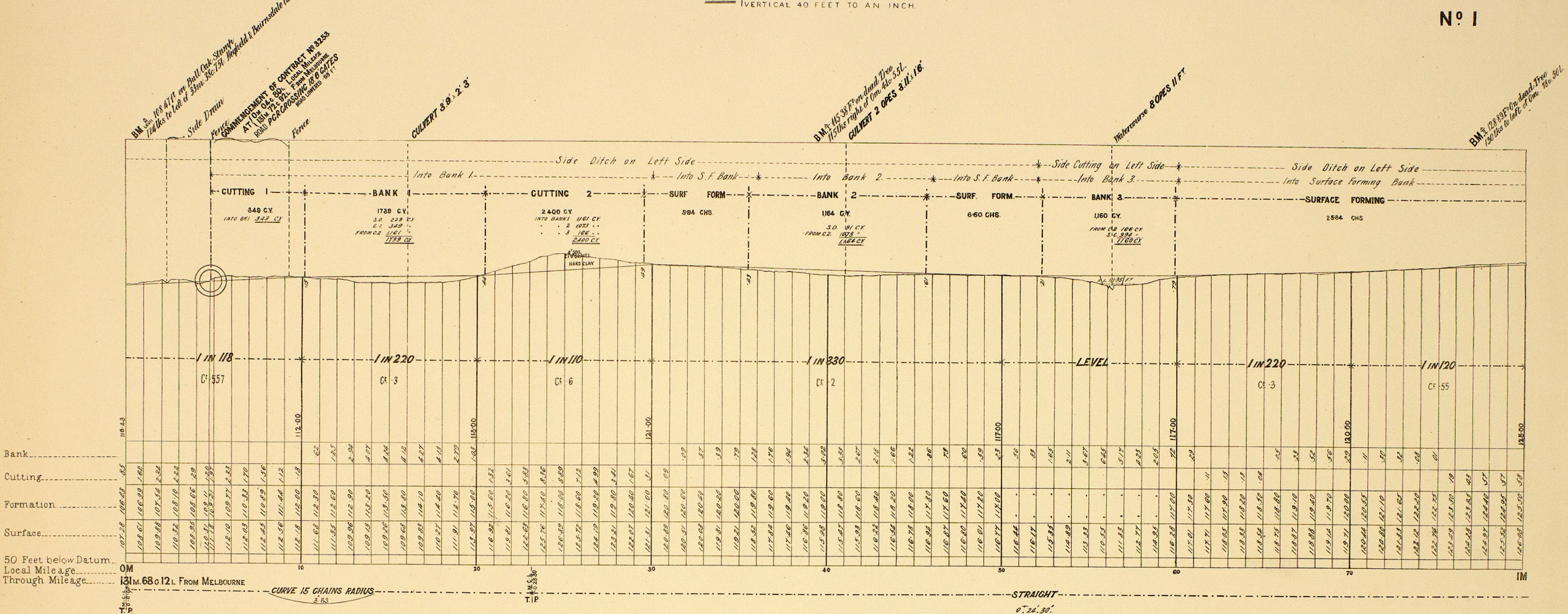

VICTORIAN RAILWAYS, MAFFRA AND BRIAGOLONG LINE.

CONTRACT N^o 3253.
N^o 2.

NOTE—Contractors must form their own judgment as to the nature of the Excavations, Borrowings and other information shown on these Sections and derived from the Surveyors' notes but are not guaranteed as correct, and the Corporation will not incur any responsibility in respect thereof.

The figures under the description of the Curves at the bottom of the Section denote the super-elevation of the outer rail; Speed 30 miles an hour.

SCALES: HORIZONTAL 4 CHAINS TO AN INCH.
VERTICAL 40 FEET TO AN INCH.

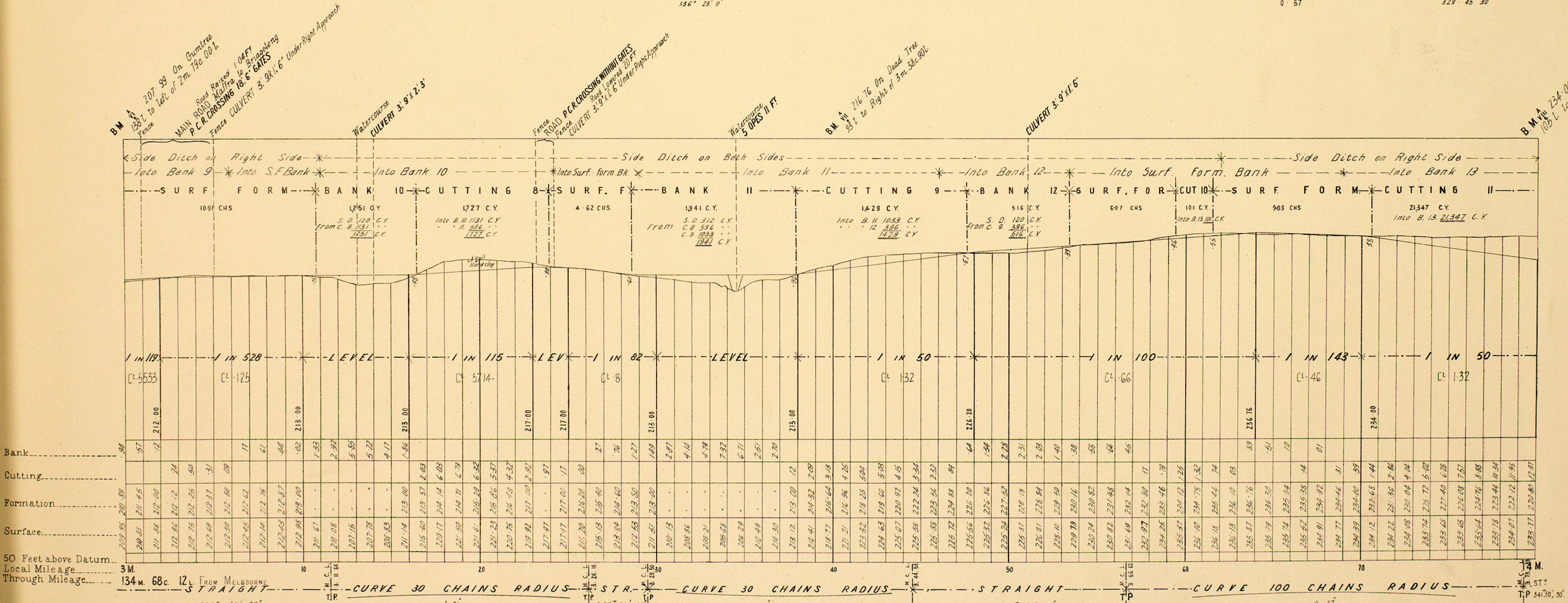
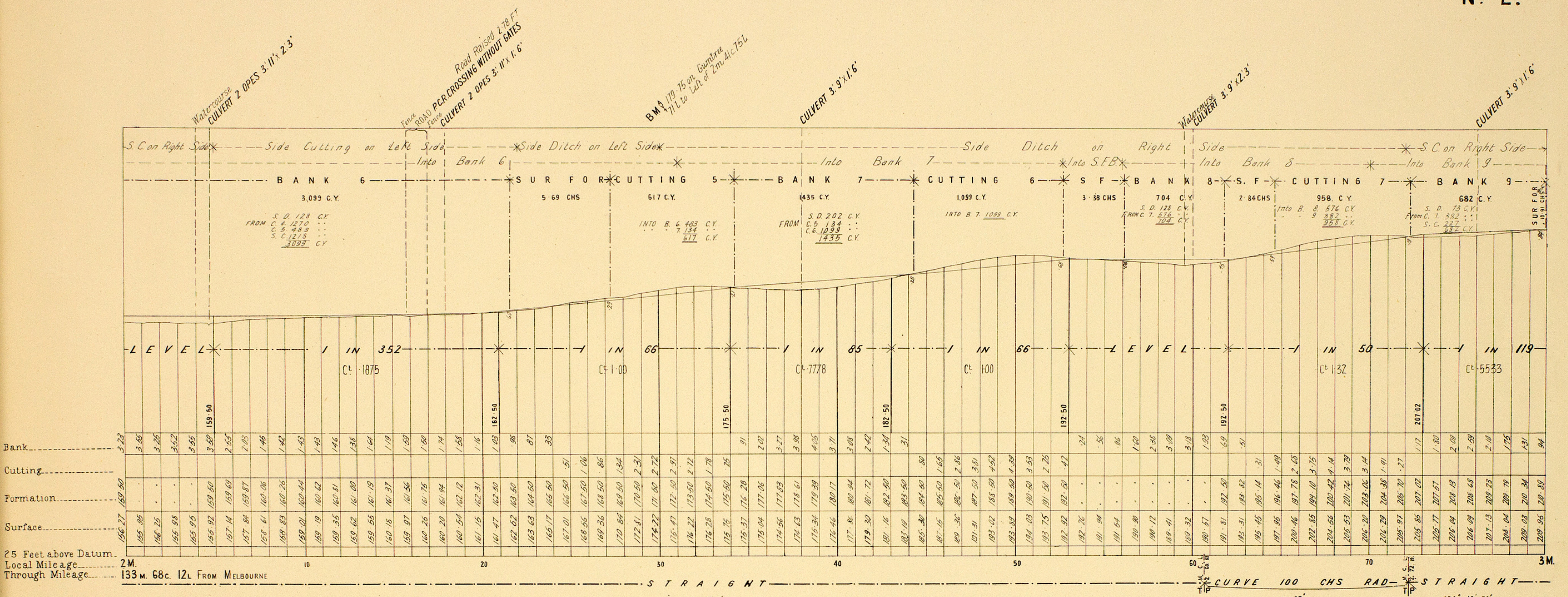

VICTORIAN RAILWAYS, MAFFRA AND BRIAGOLONG LINE.

**CONTRACT N^o 3253.
N^o 3.**

NOTE—Contractors must form their own judgment as to the nature of the Excavations, Berings and other information shown on these Sections are derived from the Surveyors' notes but are not guaranteed as correct, and the Corporation will not incur any responsibility in respect thereof.

The figures under the description of the Curves at the bottom of the Section denote the super-elevation of the outer rail; Speed 30 miles an hour.

SCALES HORIZONTAL 4 CHAINS TO AN INCH.
VERTICAL 40 FEET TO AN INCH.

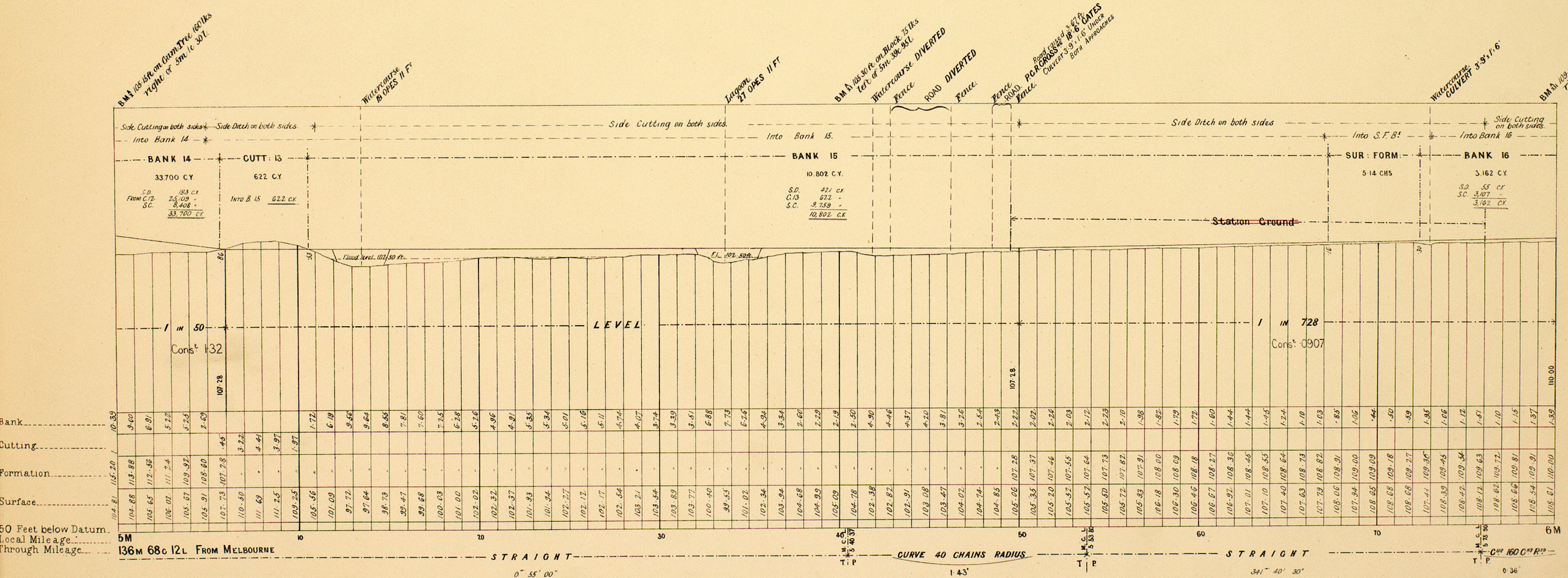
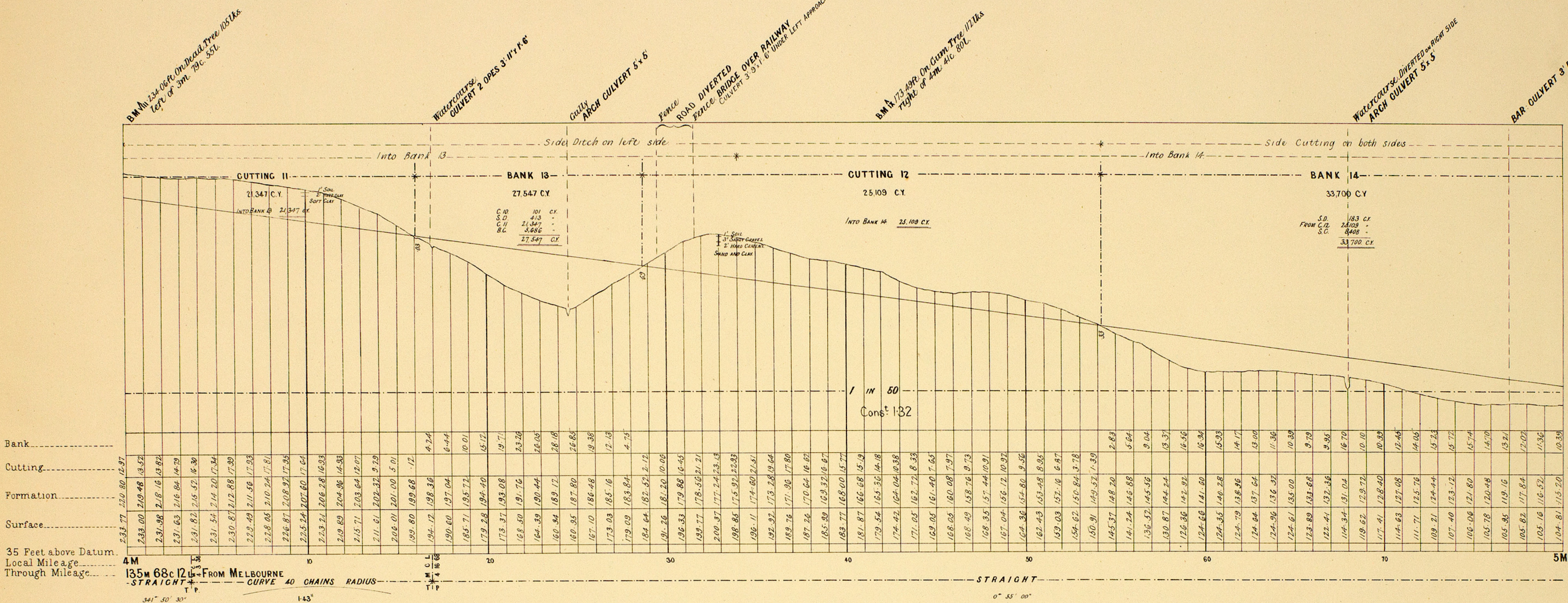

NOTE :- Contractors must form their own judgment as to the nature of the Excavations. Borings and other information shown on these Sections are derived from the Surveyors' notes but are not guaranteed as correct, and the Corporation will not incur any responsibility in respect thereof.

The figures under the description of the Curves at the bottom of the Section denote the super-elevation of the outer rail; Speed 30 miles an hour.

VICTORIAN RAILWAYS, MAFFRA AND BRIAGOLONG LINE.

SCALES (HORIZONTAL 4 CHAINS TO AN INCH.
VERTICAL 40 FEET TO AN INCH.

**CONTRACT N^o 3253.
N^o 4.**

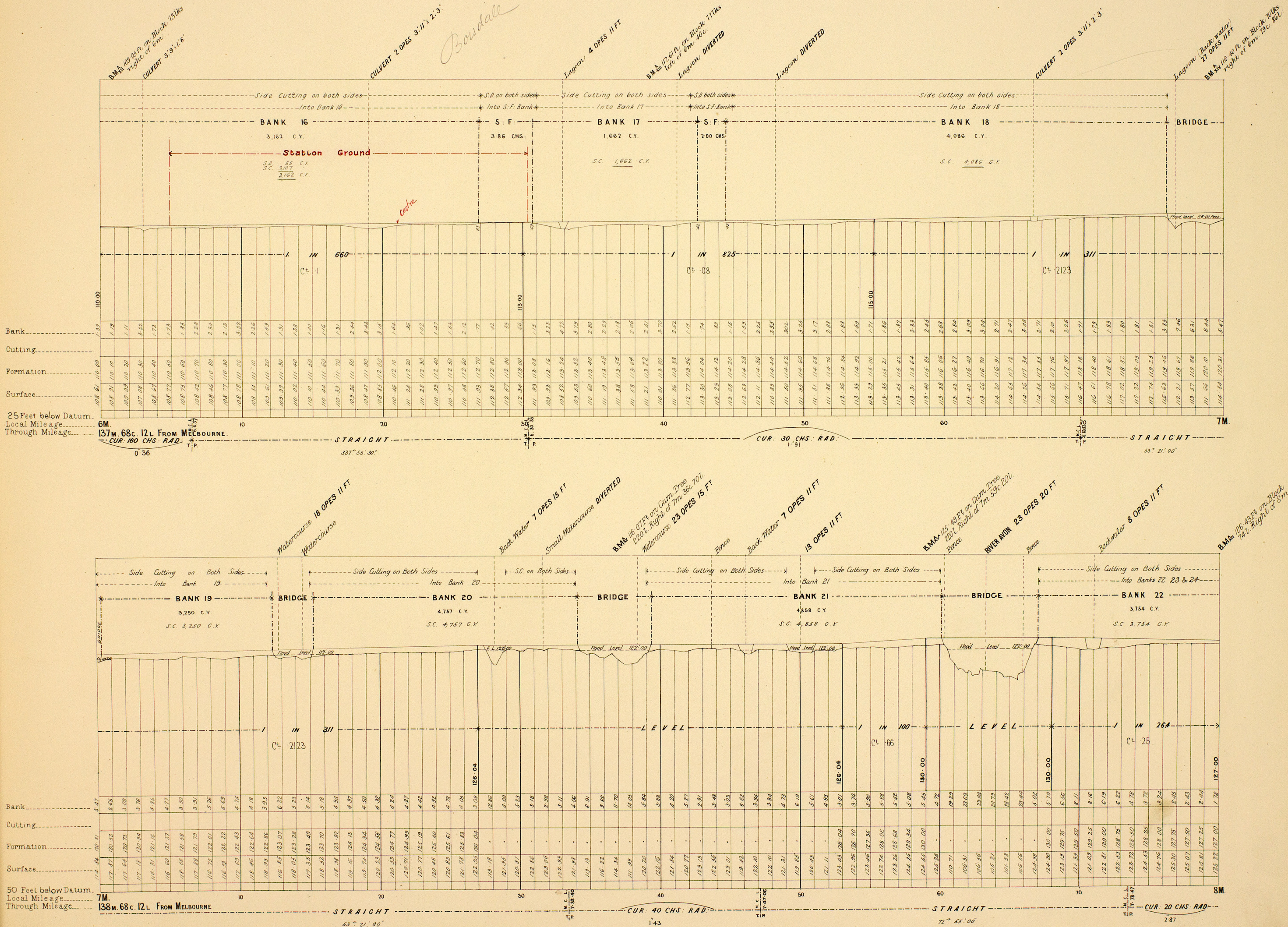

NOTE—Contractors must form their own judgment as to the nature of the Excavations Borings and other information shown on these Sections are derived from the Surveyors' notes but are not guaranteed as correct, and the Corporation will not incur any responsibility in respect thereof.

The figures under the description of the Curves at the bottom of the Section denote the super-elevation of the outer rail; Speed 30 miles an hour.

VICTORIAN RAILWAYS, MAFFRA AND BRIAGOLONG LINE.

**CONTRACT N° 3253.
N° 5.**

SCALES (HORIZONTAL 4 CHAINS TO AN INCH.
VERTICAL 40 FEET TO AN INCH.

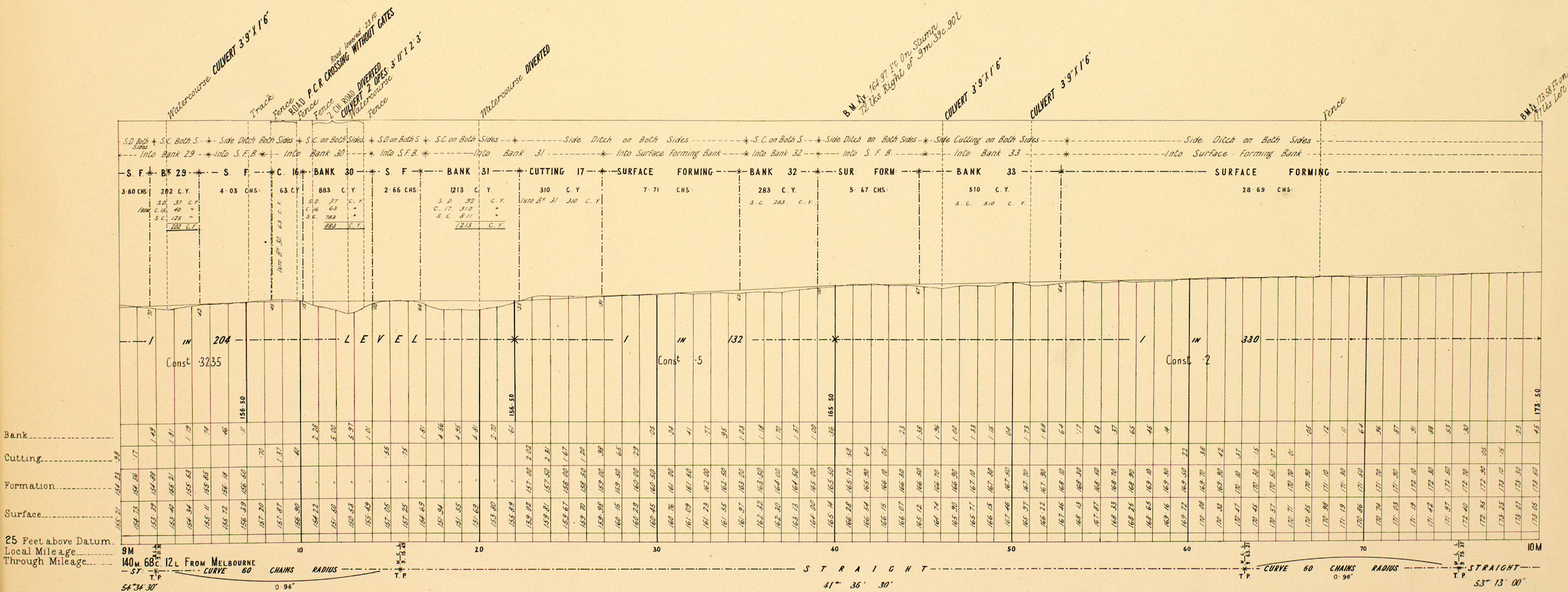
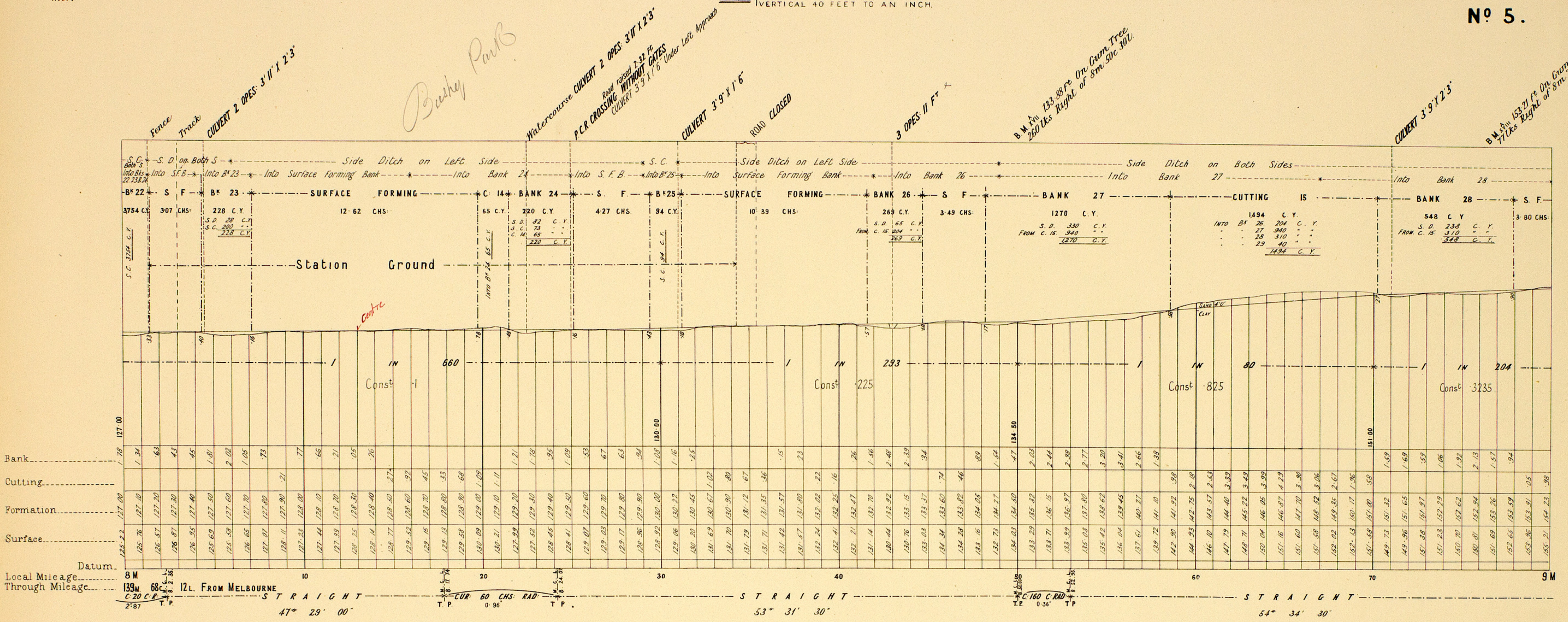

VICTORIAN RAILWAYS.

CONTRACT N^o 3253.
N^o 6.

SCALES: HORIZONTAL 4 CHAINS TO AN INCH.
VERTICAL 40 FEET TO AN INCH

NOTE: Contractors must form their own judgment as to the nature of the Excavations, Borrowings and other information shown on these Sections are derived from the Surveyors' notes but are not guaranteed as correct, and the Corporation will not incur any responsibility in respect thereof.

The figures under the description of the Curves at the bottom of the Section denote the super-elevation of the outer rail; Speed 30 miles an hour.

