

VICTORIAN RAILWAYS

NEWTOWN TO PITFIELD LINE

①
Reference No.

Plan of Land belonging to occupied by
Situating in the Parish of in the County of Grenville

SCALE 10 CHAINS TO ONE INCH

Quantity of Land required and colored red *A. R. P.* more or less.
1019'00

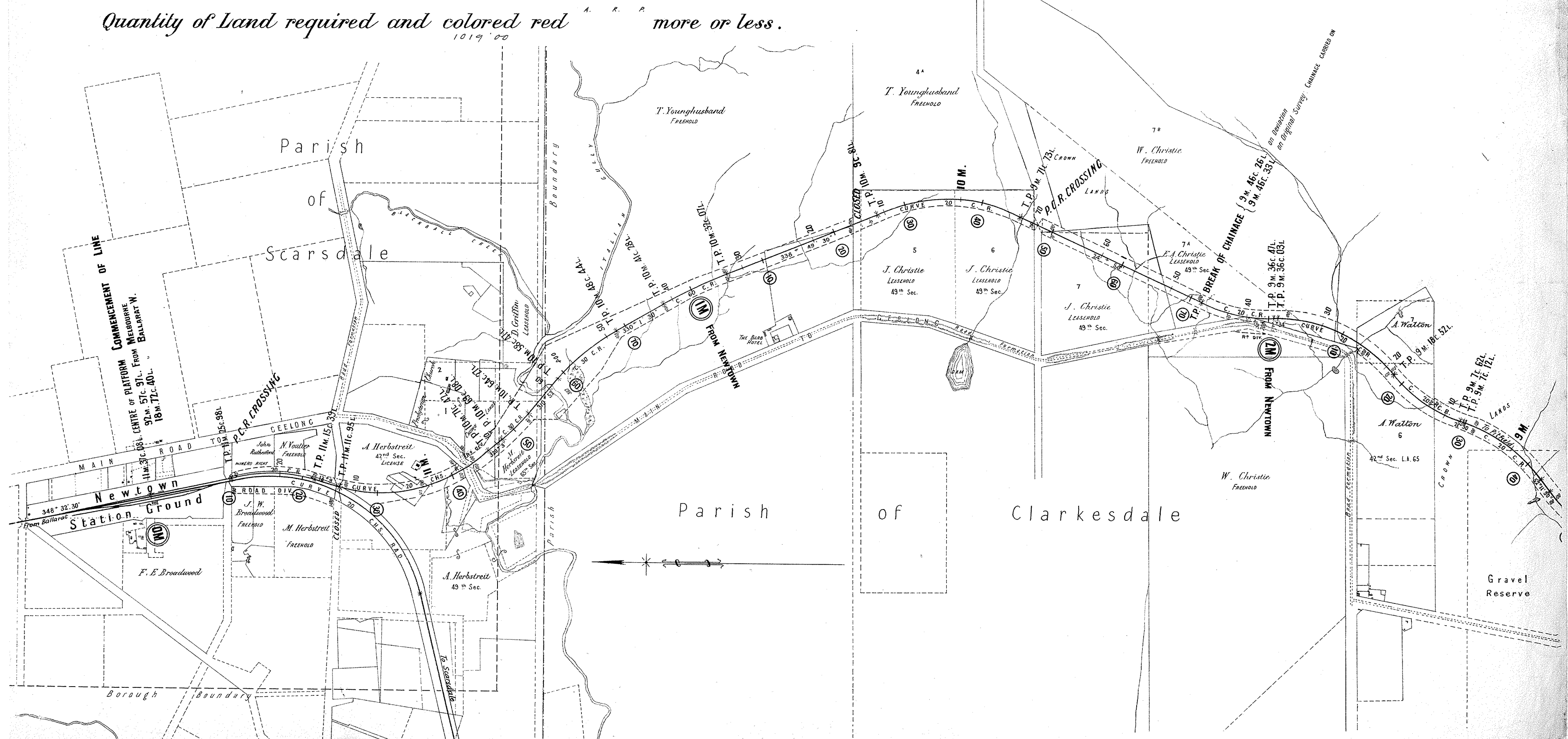

VICTORIAN RAILWAYS NEWTOWN TO PITFIELD LINE

(2)
Reference No.

Plan of Land belonging to occupied by
Situating in the Parish of Clarkesdale in the County of Grenville

SCALE 10 CHAINS TO ONE INCH

Quantity of Land required and colored red ^{A. R. P.} more or less.

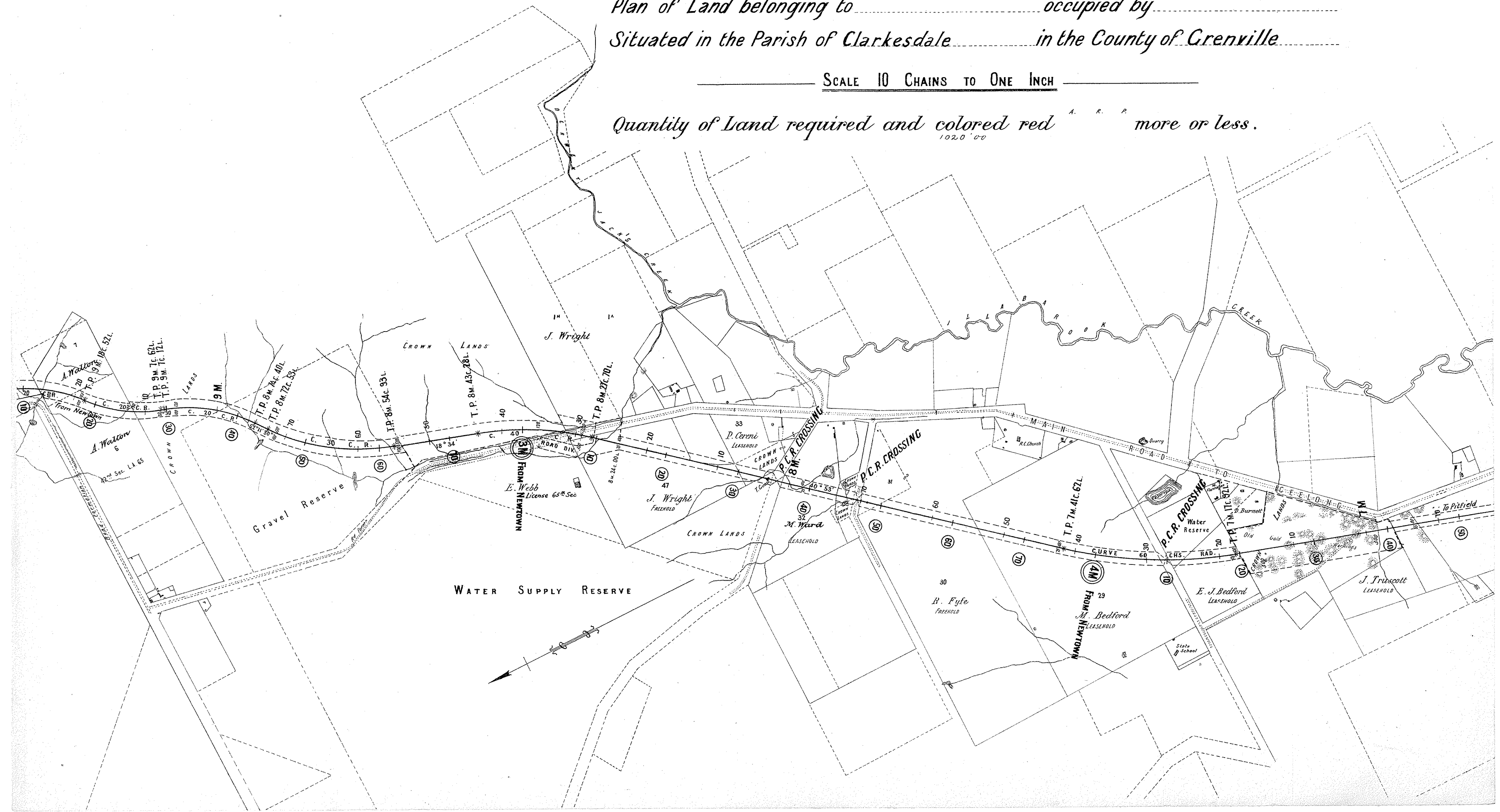

VICTORIAN RAILWAYS

NEWTOWN TO PITFIELD LINE

Plan of Land belonging to occupied by
Situating in the Parish of in the County of Grenville

SCALE 10 CHAINS TO ONE INCH

Quantity of Land required and colored red ^{A. R. P.} more or less.
1291.00

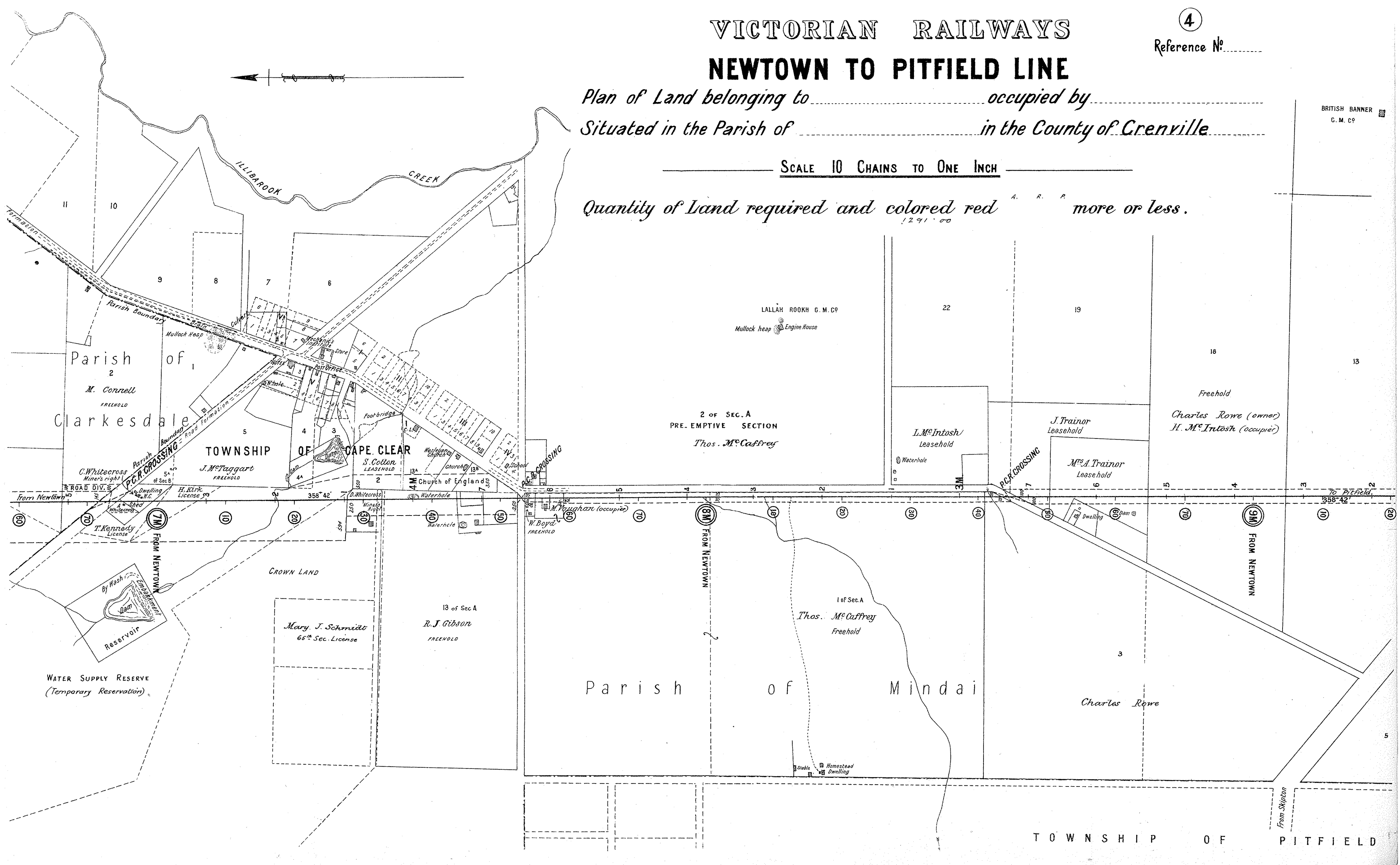

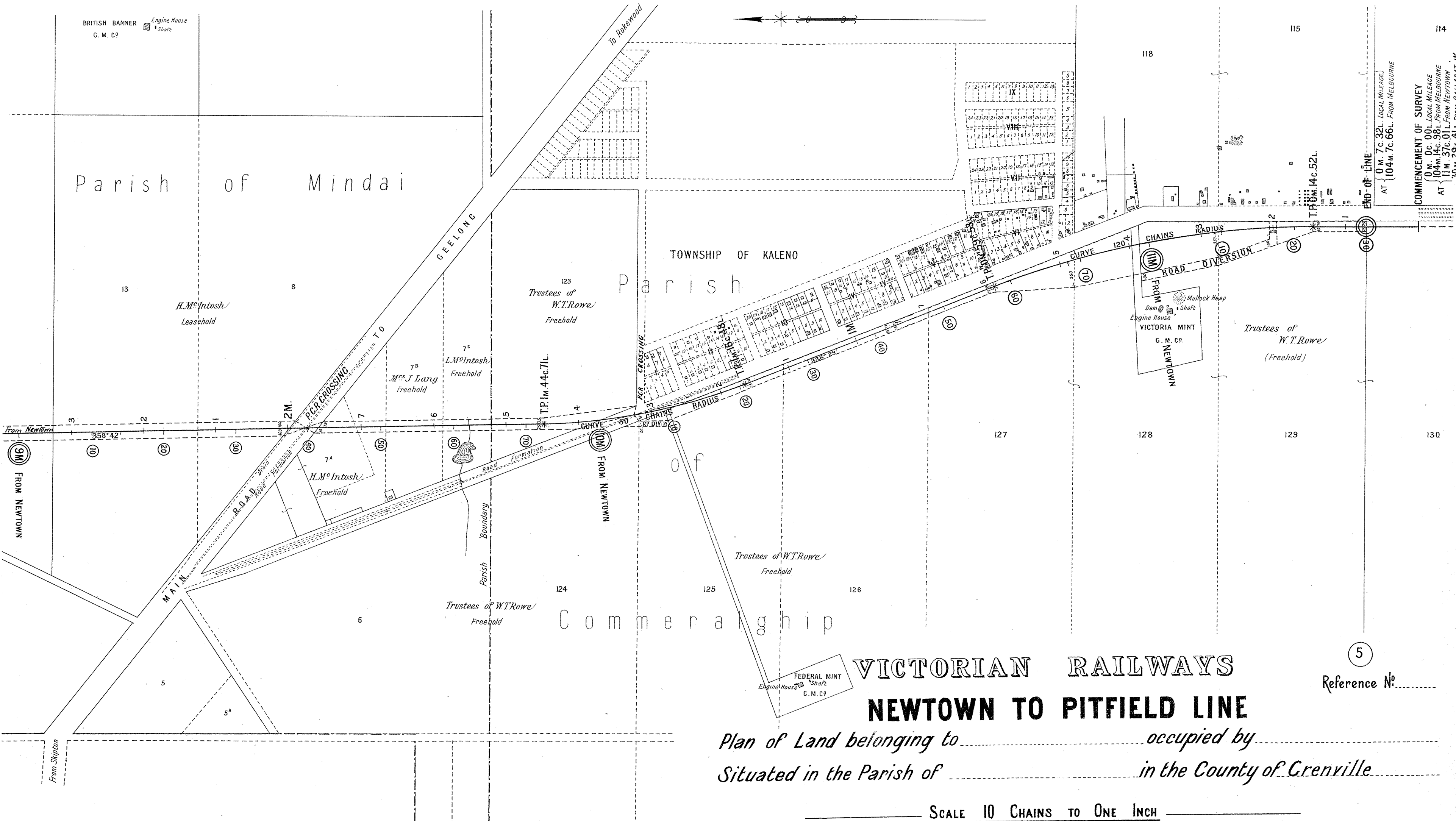

**VICTORIAN RAILWAYS
NEWTOWN TO PITFIELD LINE**

Plan of Land belonging to _____ occupied by _____
 Situated in the Parish of _____ in the County of Grenville.

SCALE 10 CHAINS TO ONE INCH

Quantity of Land required and colored red ^{A. R. P.} more or less.

5
Reference No. _____

END OF LINE
 AT 0 M. 7c. 32l. LOCAL MILEAGE
 FROM MELBOURNE
 (104 M. 7c. 66l. FROM MELBOURNE)
 COMMENCEMENT OF SURVEY
 AT 0 M. 0c. 00l. LOCAL MILEAGE
 FROM MELBOURNE
 (104 M. 14c. 38l. FROM MELBOURNE)
 AT 11 M. 37c. 01l. FROM NEWTOWN
 (30 M. 29c. 41l. FROM BALLARAT, W.)

FEDERAL MINT
 Engine House
 Shaft
 C. M. C^o

Mullock Heap
 Dam
 Engine House
 Shaft
 VICTORIA MINT
 C. M. C^o

BRITISH BANNER
 Engine House
 Shaft
 C. M. C^o

9M
 FROM NEWTOWN

10M
 FROM NEWTOWN

From Skipton

Commeranghip

TOWNSHIP OF KALENO

Parish of Mindai

Parish

Trustees of W.T. Rowe
 Freehold

Trustees of W.T. Rowe
 Freehold

Trustees of W.T. Rowe
 (Freehold)

H.M. Intosh
 Leasehold

M. J. Lary
 Freehold

L.M. Intosh
 Freehold

Trustees of W.T. Rowe
 Freehold

H.M. Intosh
 Freehold

124

125

126

127

128

129

130

13

8

118

115

114

T.P.M. 14c. 52l.

2 M.

P.C.R. CROSSING

358° 42'

From Newtown

80

80

80

80

80

80

80

80

80

80

80

80

80

80

80

80

80

80

9M

9M

9M

9M

9M

9M

9M

9M

9M

9M

9M

9M

9M

9M

9M

9M

9M

9M

9M

9M

9M

9M

9M

9M

9M

9M

9M

9M

9M

9M

9M