



**VICTORIAN RAILWAYS,
WEDDERBURN ROAD AND WEDDERBURN LINE.**

Plan of Land

(1)^x
Reference Number

Belonging to Occupied by

Situated in the Parish of Wedderburn — in the County of Gladstone

Scale 10 Chains to 1 Inch.

Quantity of Land required and colored red ^{A. R. P.} more or less.
1565 '90.

VICTORIAN RAILWAYS,
WEDDERBURN ROAD AND WEDDERBURN LINE. ③^x

Plan of Land

Reference Number

Belonging to _____ Occupied by _____
Situating in the Parish of Wedderburn in the County of Gladstone.

Scale, 4 Chains to 1 inch.

Quantity of Land required and colored red more or less.

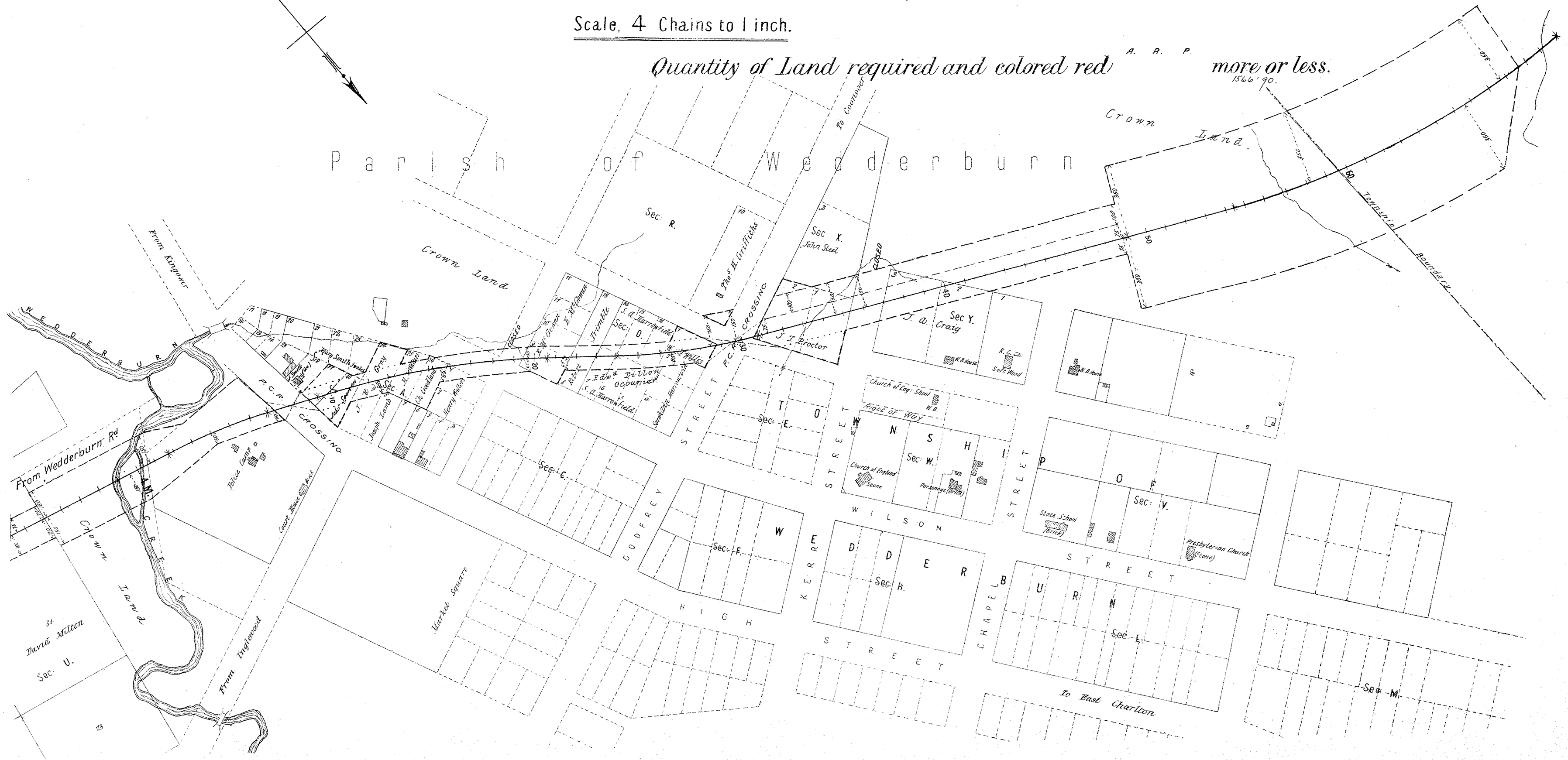

VICTORIAN RAILWAYS, WEDDERBURN ROAD STATION AND WEDDERBURN LINE.

SCALE. 10 CHAINS TO AN INCH.

CONTRACT N^o 2420.
N^o 2.



VICTORIAN RAILWAYS,
WEDDERBURN ROAD STATION AND WEDDERBURN LINE.

SCALE 4 CHAINS TO AN INCH.

CONTRACT NO 2420.
NO 2^A

