

3/10

VICTORIAN RAILWAYS

Castlemaine & Dundley Line

Tracing showing proposed road diversions
to Level Crossing near Station at Newstead

Scale 4 Chains to an Inch

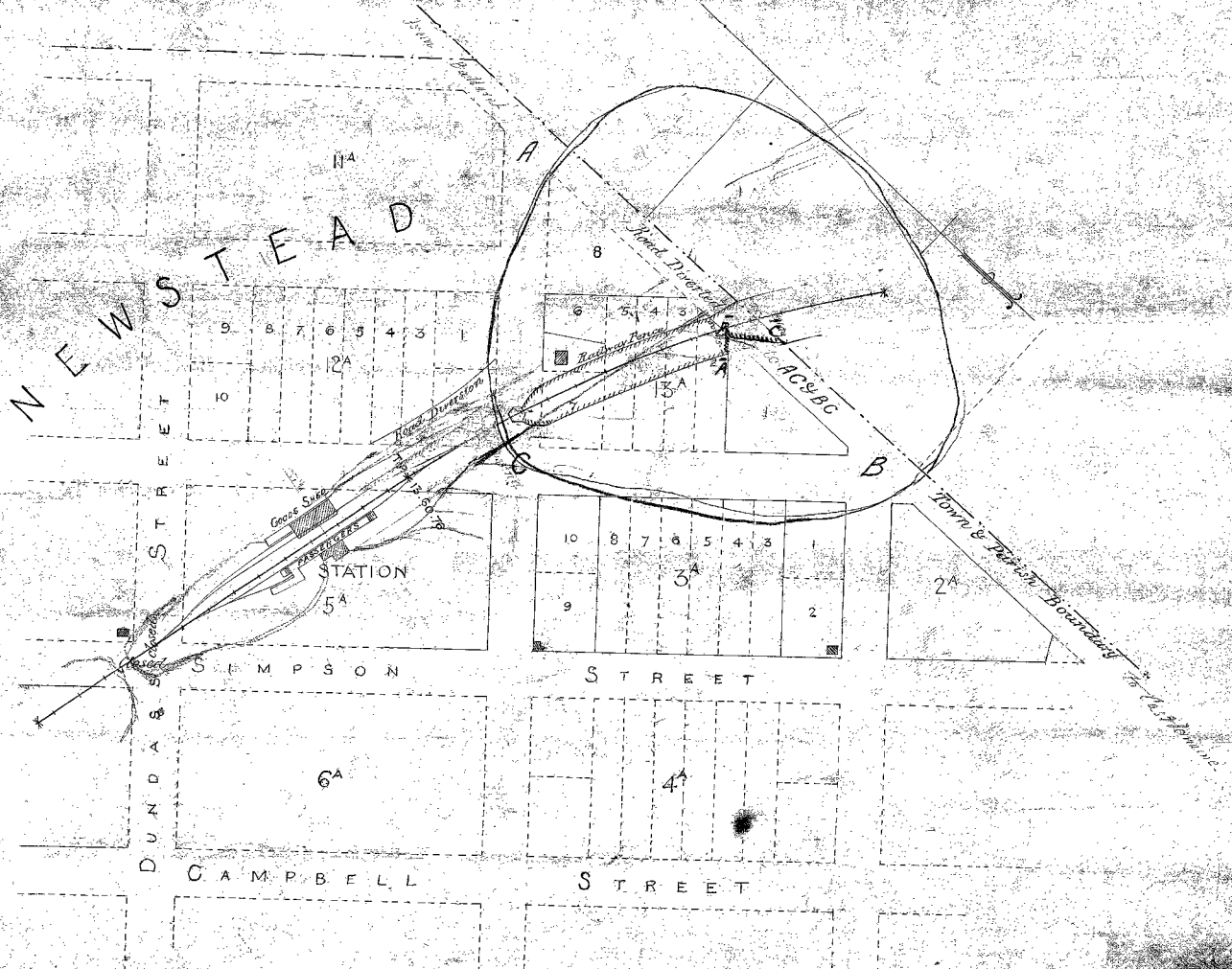

Made a tracing showing the partition within
the red circles with exception A-B-C was done to
Mr W. Wilson on the 20/1/73. See diagram showing A-B-C
found on the 21/1/73 with instructions to fence a line marked
by red dotted lines - (supplement)
The tracing was also for the purpose of showing the same generally of the level crossing
and position of the level crossing house (the large house plan is later side S 29/1/73)

There are two descriptions
of the fence
set out in the plan
at the station side of the fence
C. W. Price
19/1/73